

T. 18 N. R. 18 E. W. M.

KITTITAS COUNTY  
STATE OF WASHINGTON

SCALE  
HORIZ. 1" = 200'  
VERT. 1" = 20'  
APPROVED *[Signature]*  
COUNTY COMMISSIONERS  
MEMBER *[Signature]*  
MEMBER *[Signature]*  
RA 59

PROJECT NO. 49-A

*Cancelled*

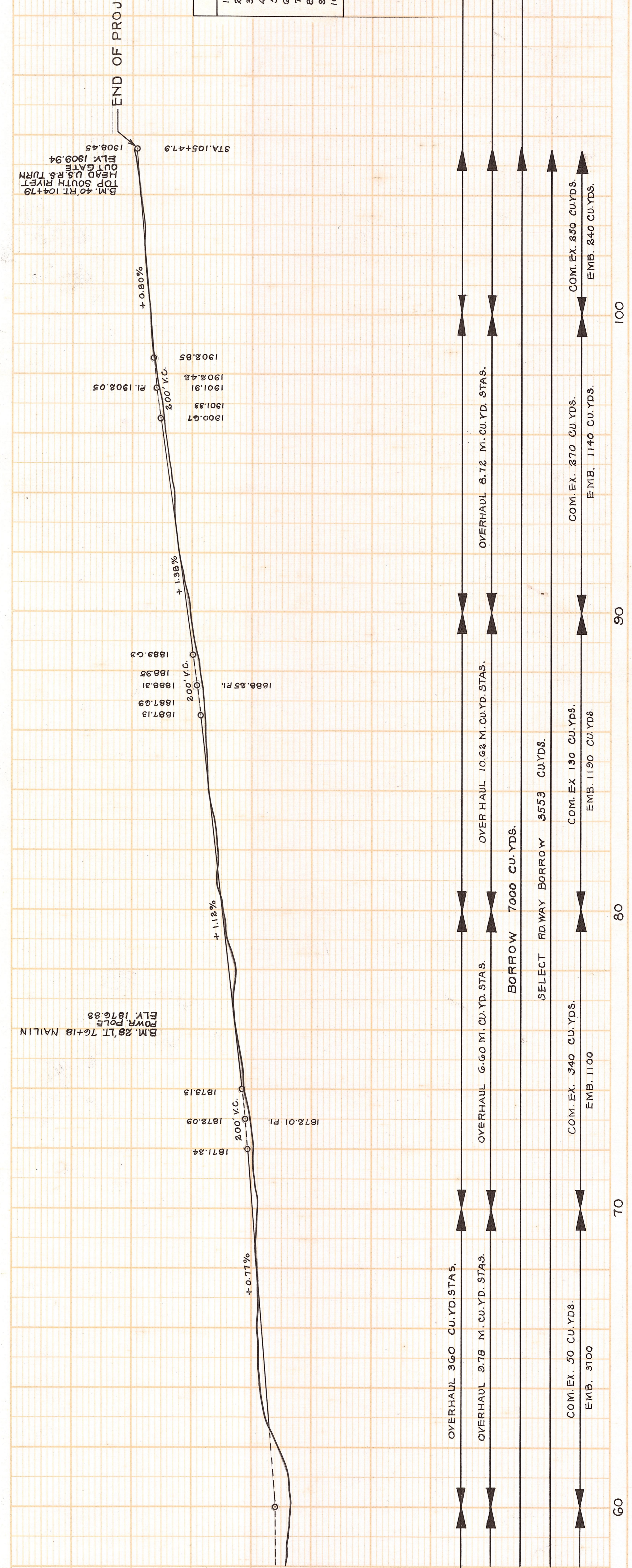
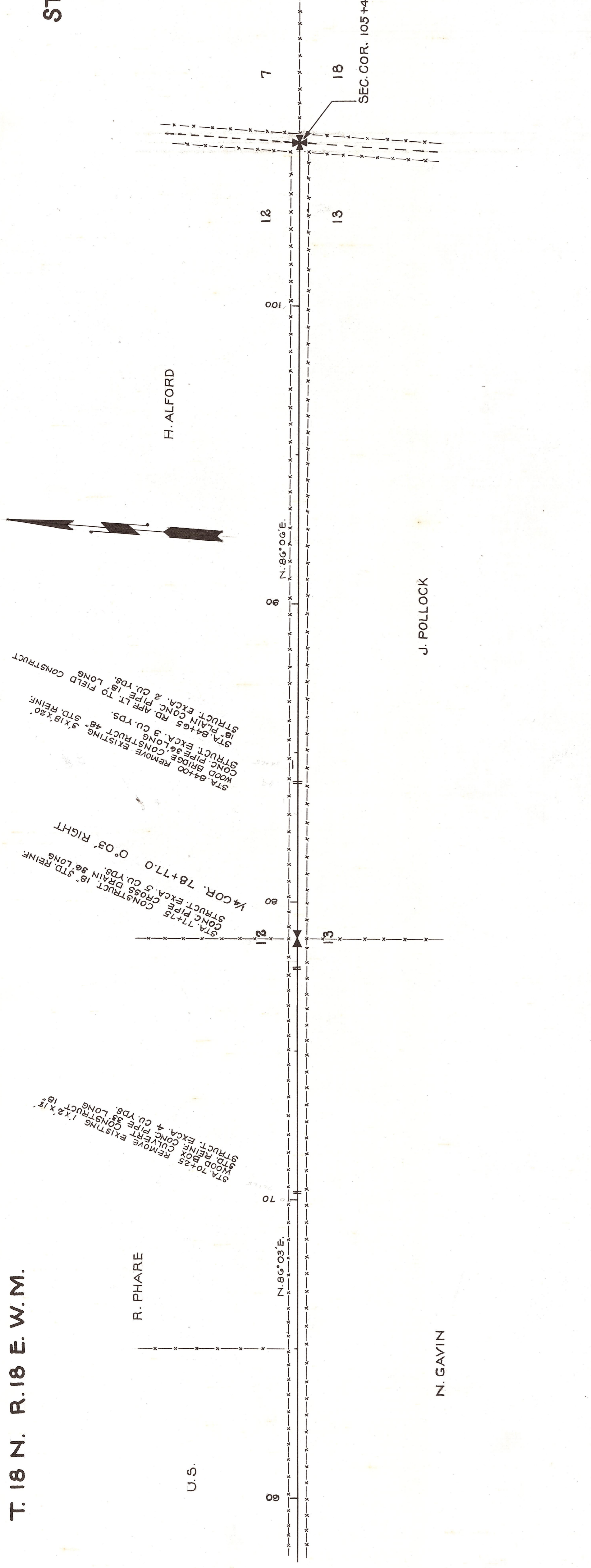

SUMMARY MILE 2 (PART)			
1	COMMON EXCA.	CU. YDS.	2200
2	STRUCTURE "	"	20
3	BORROW "	"	7000
4	SELECT RD. WAY BORROW	"	3553
5	OVERHAUL	CU. YD. STAS.	3430
6	"	"	3572
7	SURFACING 3/4" MINUS C.R.	CU. YDS.	670
8	PLAIN CONCRETE PIPE 18"	LN. FT.	175
9	STD. REINF. " " 18"	"	177
10	" " " " 48"	"	56

DATE	BY	REVISION

DATE	BY	REVISION