

16-3-91
2-3-91

KITTITAS COUNTY,
WASHINGTON.

PLAN OF CONCRETE CULVERT.
AT MORRISON CANYON
ELLENSBURG, WASH. JULY 11, 1914.

Scale: 1 in = 2 ft.

Correct: _____
County Engineer.

13.4 Cu. Yds. Concrete

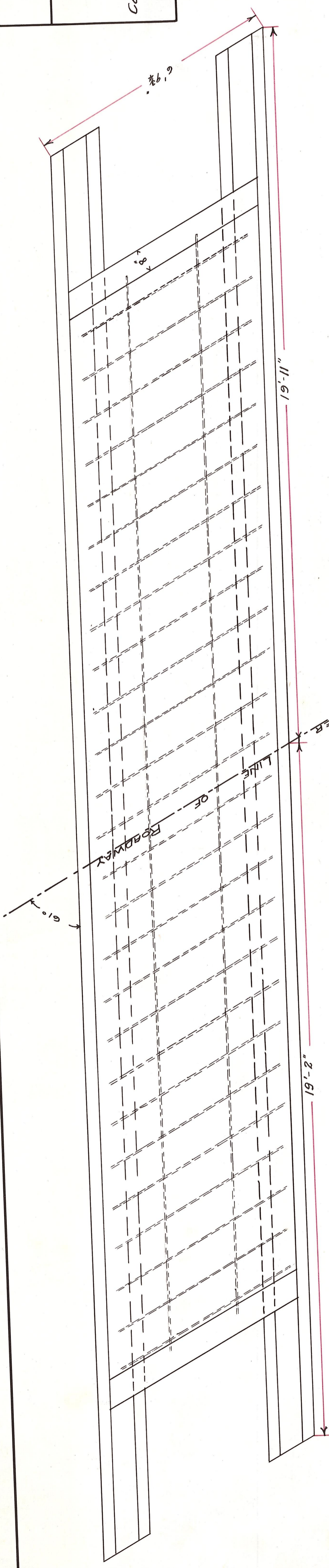

CROSS-SECTION.

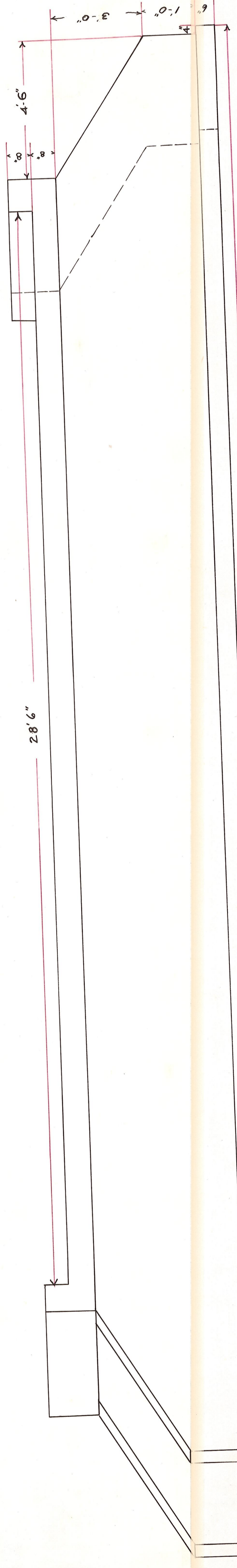
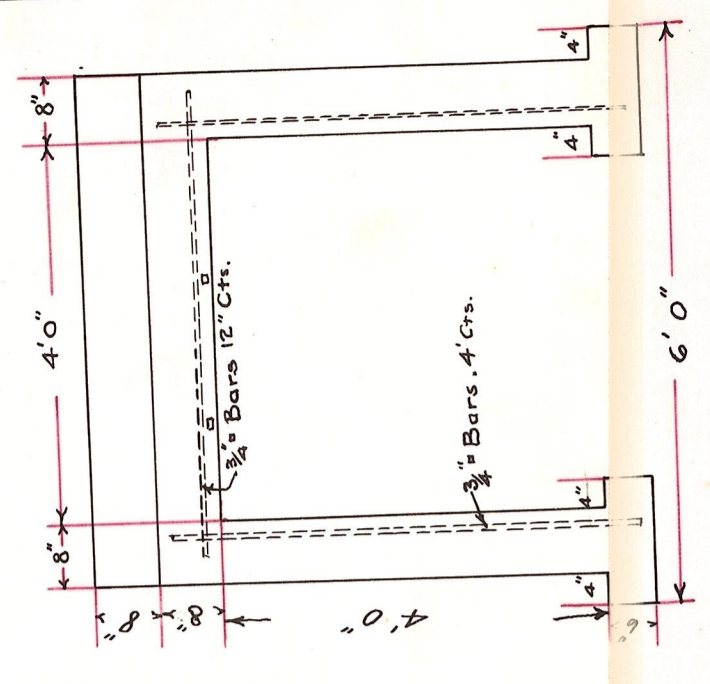

39'-1"

12-1
19-6

MITTAS COUNTY,
WASHINGTON.

PLAN OF CONCRETE CULVERT.
AT MORRISON CANYON
ELLENSBURG, WASH. JULY 11, 1914.
Scale: 1 in = 2 ft.

Correct:

County Engineer.

13.1 Cu. Yds. Concrete
13.1 CUYARDS

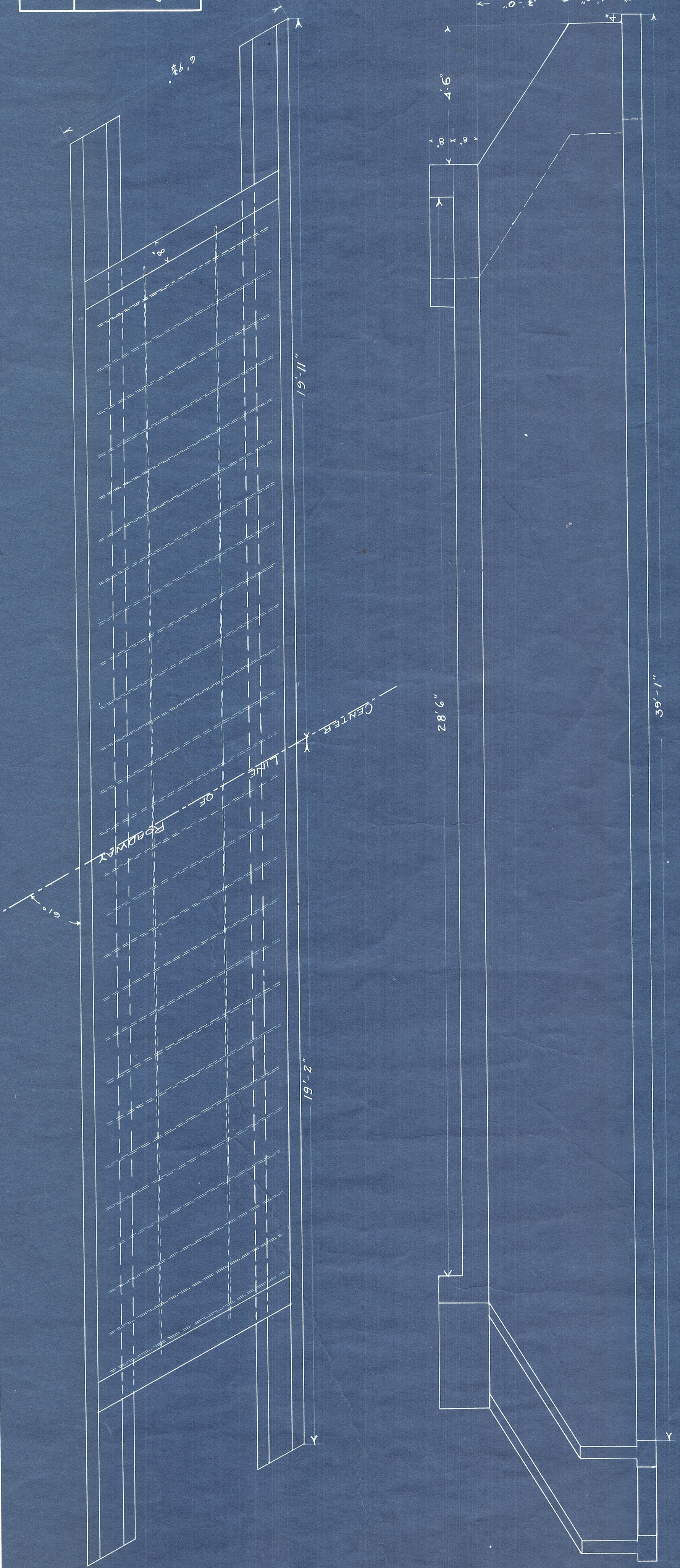

Road 44
Road 844
1914
14-6-1

Culvert at Morrison Canyon