

1.18 N.R.17 E.
1.18 N.R.18 E.

25 30
36 31

STA 63+24
SECTION CORNER
FOUND 1-1/2" PIPE
WITH NAIL

CENTERLINE AND SECTION LINE
CONVERGE AT THE SECTION CORNER

APPROACH

18"x27" CONC.

TOP OF BANK

BOTTOM OF DITCH

TOP OF BANK

BOTTOM OF DITCH

APPROACH

12"x20" PVC

TOP OF BANK

BOTTOM OF DITCH

TOP OF BANK

BOTTOM OF DITCH

TOP OF BANK

BOTTOM OF DITCH

TOP OF BANK

BOTTOM OF DITCH

TOP OF BANK

BOTTOM OF DITCH

TOP OF BANK

BOTTOM OF DITCH

FOUND 5/8" IRON PIN
L.S. # 12491

30 31

N.90°00'00"E
2604.67'

ROBINSON CANYON

S.89°12'23"E
1,263.50'

ROAD

N.89°29'47"E

CENTERLINE IS SOUTH OF SECTION
LINE AT THE 1/4 SEC. COR.

ROAD SHOULDER

EDGE OF PAVEMENT

ROAD SHOULDER

EDGE OF PAVEMENT

ROAD SHOULDER

EDGE OF PAVEMENT

ROAD SHOULDER

EDGE OF PAVEMENT

ROAD SHOULDER

EDGE OF PAVEMENT

ROAD SHOULDER

EDGE OF PAVEMENT

ROAD SHOULDER

EDGE OF PAVEMENT

ROAD SHOULDER

EDGE OF PAVEMENT

ROAD SHOULDER

EDGE OF PAVEMENT

BOTTOM OF DITCH

30° SKEW

48"x30" CMP

TOP OF BANK

EDGE OF WATER

TOP OF BANK

EDGE OF WATER

TOP OF BANK

EDGE OF WATER

TOP OF BANK

EDGE OF WATER

TOP OF BANK

EDGE OF WATER

TOP OF BANK

EDGE OF WATER

TOP OF BANK

EDGE OF WATER

TOP OF BANK

N

PUBLIC WORKS DEPARTMENT
KITTITAS COUNTY
ELLENSBURG, WASHINGTON
ROBINSON CANYON ROAD
OVER WESTSIDE DITCH
BRIDGE NO.88301

SCALE: H V 1"=10'
DRAWN BY J.N. DATE February 1988 SHEET 1 OF 2
APPROVED: _____ DATE _____ PUBLIC WORKS DIRECTOR

LOADING: HS20-44

RIGHT APPROACHES LEFT



RIGHT APPROACHES LEFT

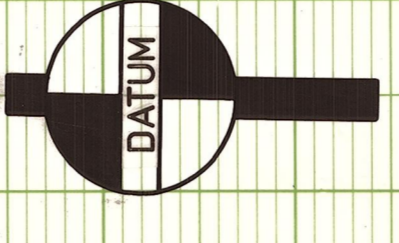

BUREAU OF RECLAMATION
BRASS CAP AT N.W. COR.
OF COVE RD. & CATLIN RD.
ELEV. 1774.02'

STA 49+50 1668.70'

STA 50+60.50 POINT 1670.38'

STA 50+78.19 ELEV. 1670.54'

STA 50+88.69 CENTER OF BRIDGE

STA 50+99.19 ELEV. 1670.59'

STA 52+00 1671.04'

1675.00

1670.00

1665.00

1660.00

1675.00

1670.00

1665.00

1660.00

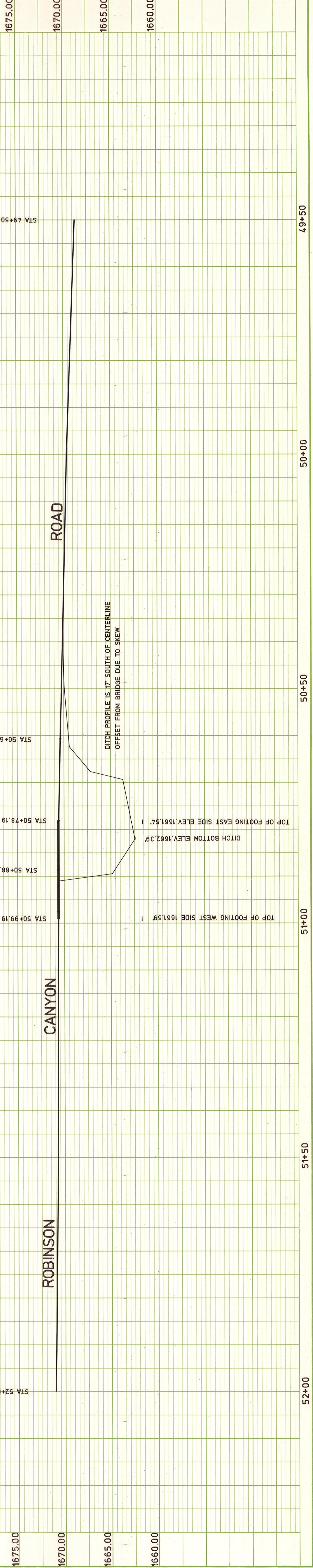

DATE _____ BY _____

NO. _____
NOTE BOOK _____
ASSIGNMENT CHECKED _____
BY _____

DATE _____ BY _____

NO. _____
NOTE BOOK _____
STRUCTURE NOTATIONS CHECKED _____
BY _____

DATE _____ BY _____

NO. _____
NOTE BOOK _____
R.M. NOTED _____
PLOTS CHECKED _____
BY _____

DATE _____ BY _____

NO. _____
NOTE BOOK _____
R.M. NOTED _____
PLOTS CHECKED _____
BY _____

DATE _____ BY _____

NO. _____
NOTE BOOK _____
R.M. NOTED _____
PLOTS CHECKED _____
BY _____

DATE _____ BY _____

NO. _____
NOTE BOOK _____
R.M. NOTED _____
PLOTS CHECKED _____
BY _____

DATE _____ BY _____

NO. _____
NOTE BOOK _____
R.M. NOTED _____
PLOTS CHECKED _____
BY _____

DATE _____ BY _____

NO. _____
NOTE BOOK _____
R.M. NOTED _____
PLOTS CHECKED _____
BY _____

DATE _____ BY _____

NO. _____
NOTE BOOK _____
R.M. NOTED _____
PLOTS CHECKED _____
BY _____

DATE _____ BY _____

NO. _____
NOTE BOOK _____
R.M. NOTED _____
PLOTS CHECKED _____
BY _____

DATE _____ BY _____

NO. _____
NOTE BOOK _____
R.M. NOTED _____
PLOTS CHECKED _____
BY _____

DATE _____ BY _____

NO. _____
NOTE BOOK _____
R.M. NOTED _____
PLOTS CHECKED _____
BY _____

DATE _____ BY _____

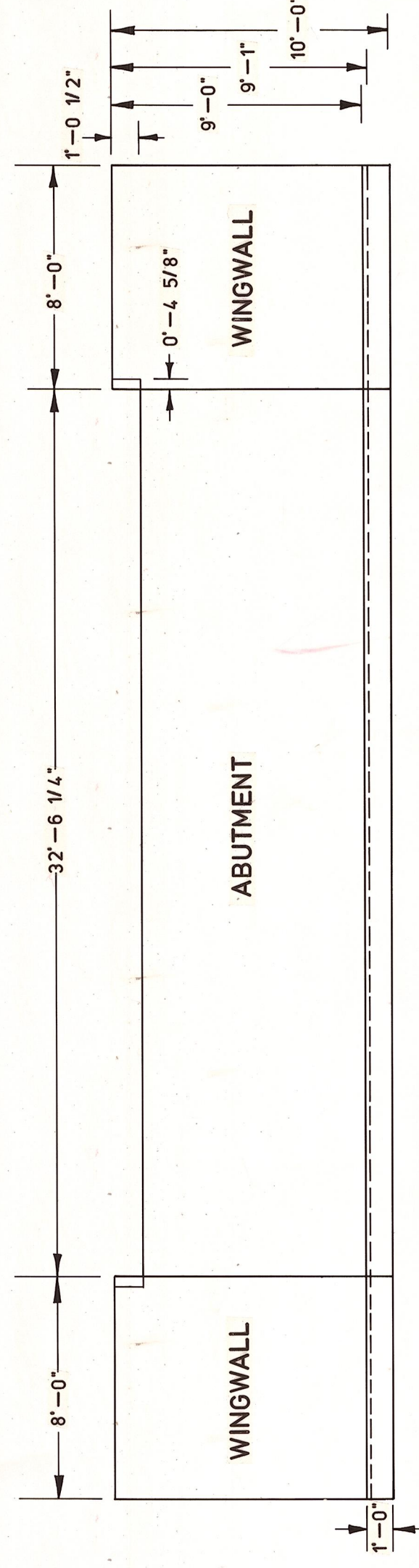
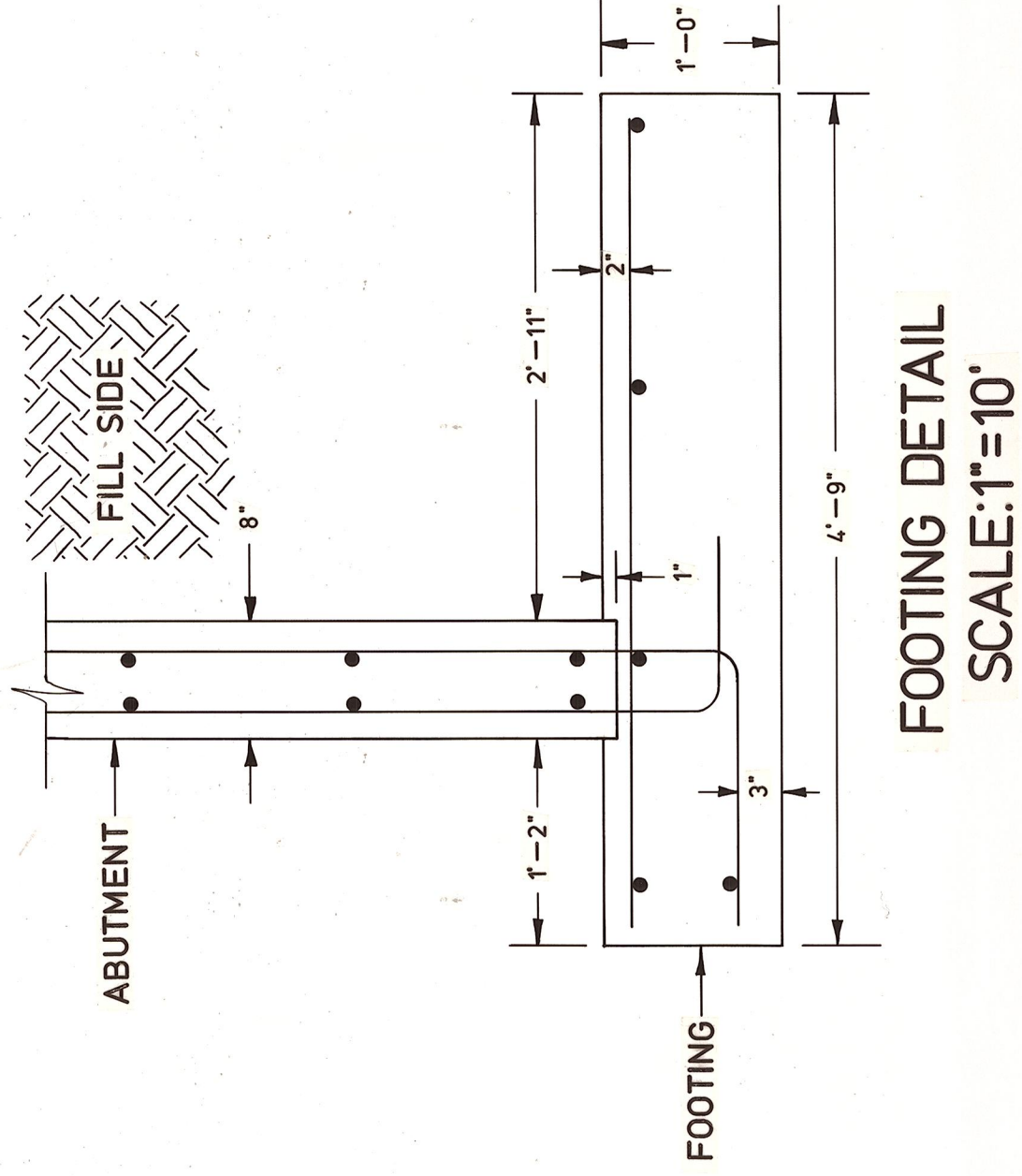
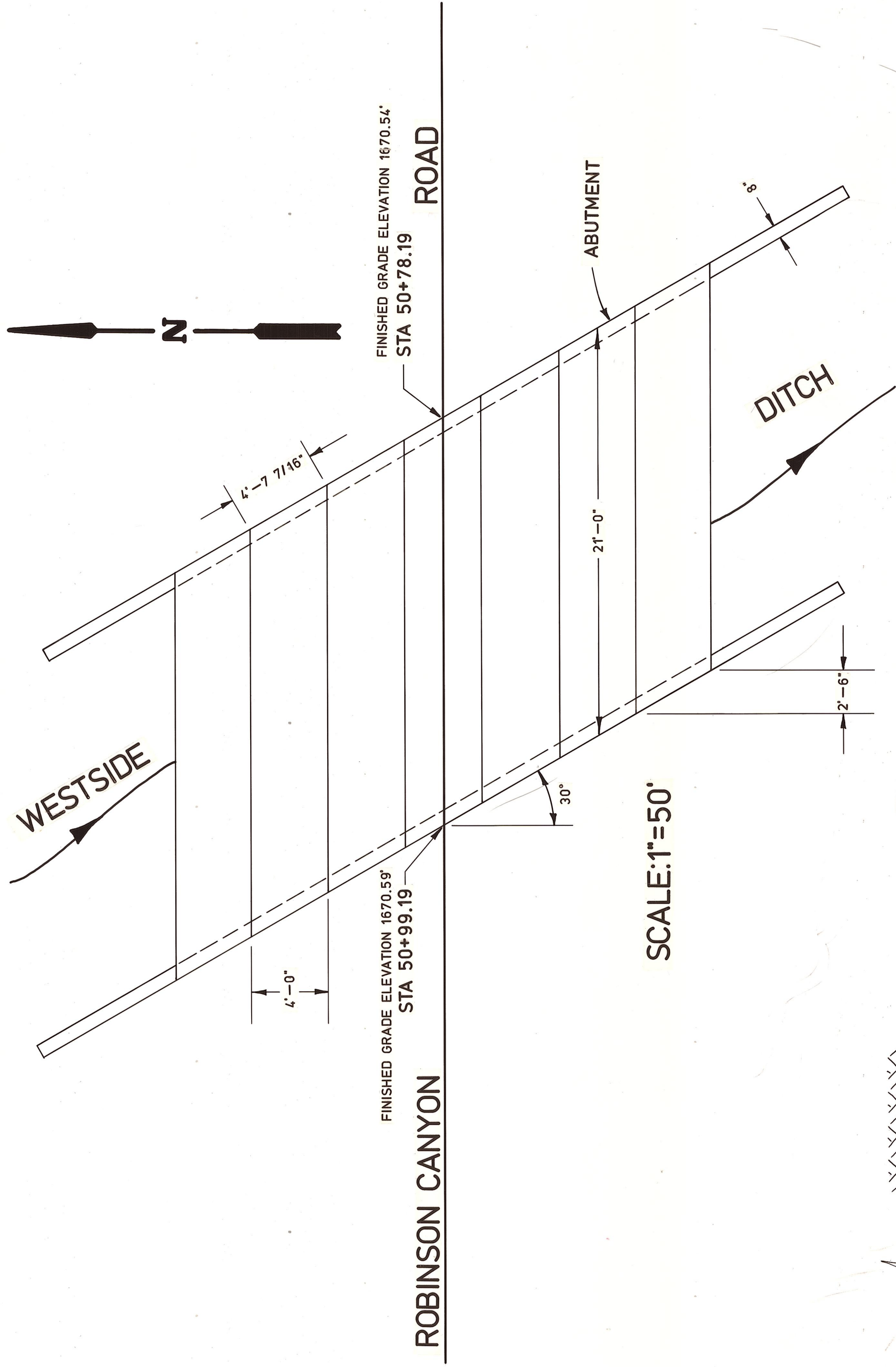

ABUTMENT DETAIL
SCALE: 1"=50'

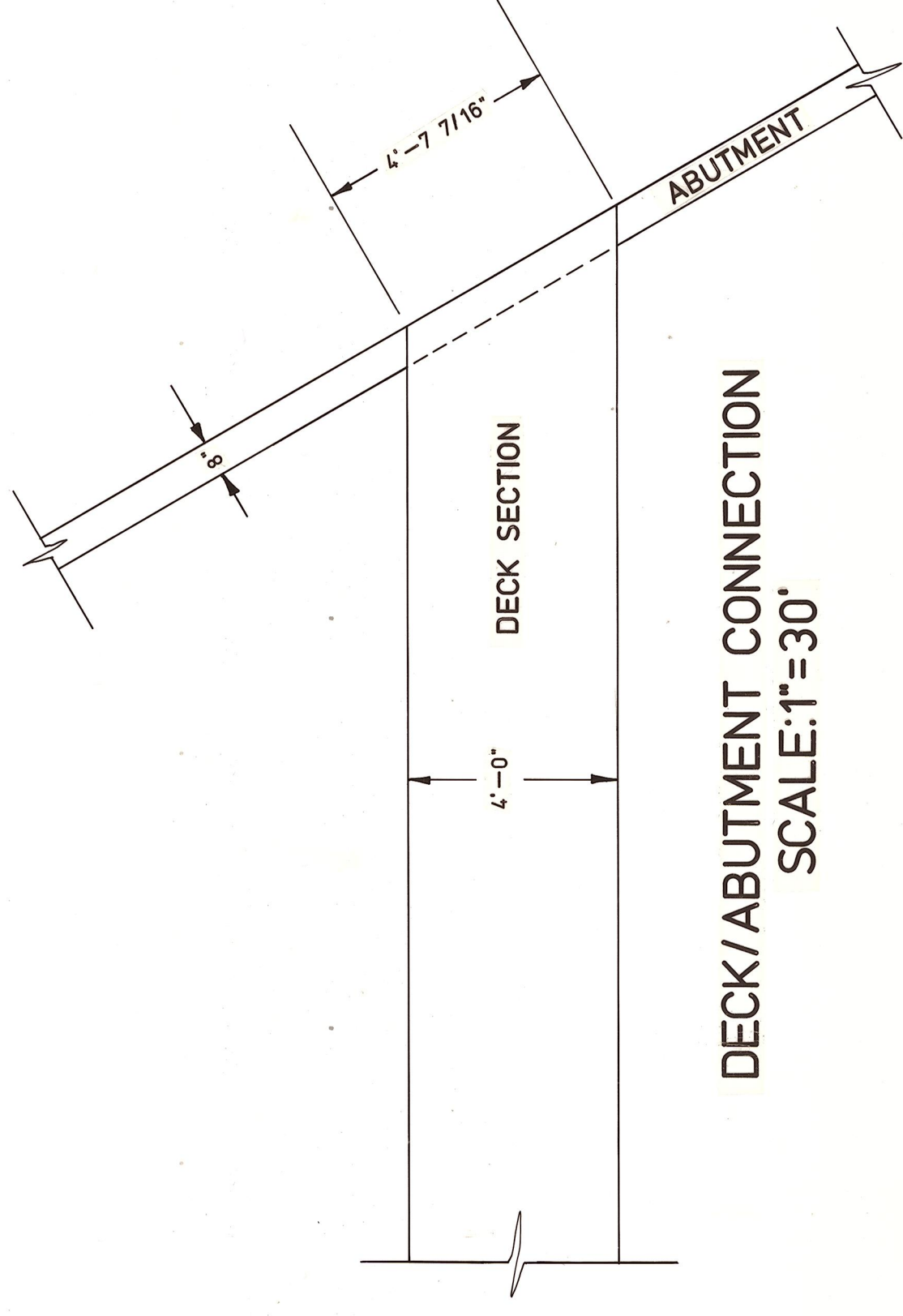

DECK/ABUTMENT CONNECTION
SCALE: 1"=30'

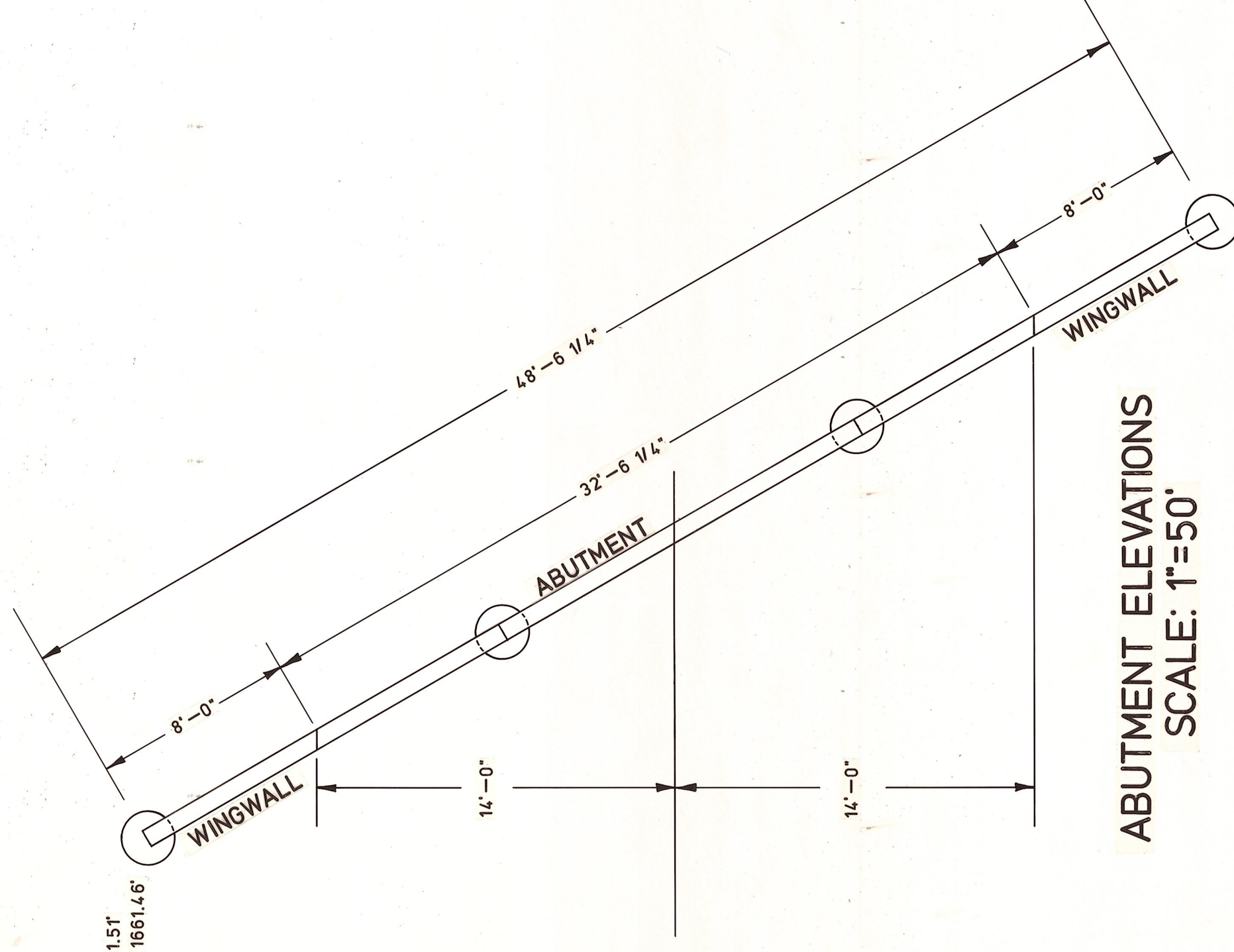

ABUTMENT ELEVATIONS
SCALE: 1"=50'

TOP OF WEST ABUTMENT BARREL ELEV. 1661.51'
TOP OF EAST ABUTMENT BARREL ELEV. 1661.46'

TOP OF WEST ABUTMENT BARREL ELEV. 1661.51'
TOP OF EAST ABUTMENT BARREL ELEV. 1661.46'

LOADING: HS20-44

DEPARTMENT OF PUBLIC WORKS

KITTITAS COUNTY
ELLENSBURG, WASHINGTON
ROBINSON CANYON ROAD
OVER WESTSIDE DITCH
BRIDGE NO.88301

SCALE: H VARIOUS C R P 77-88

DRAWN BY J.M. DATE February 1988 SHEET 2 OF 2

APPROVED: _____ DATE _____

DIRECTOR OF PUBLIC WORKS