

BOX SECTION

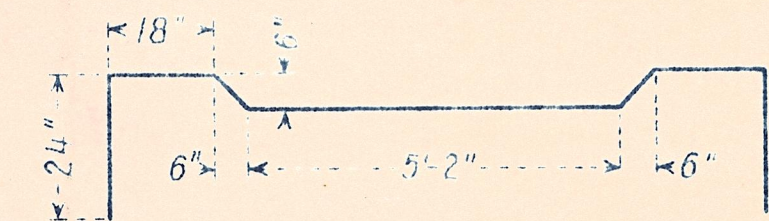

A-BAR

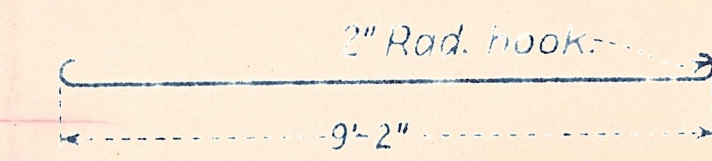

B-BAR

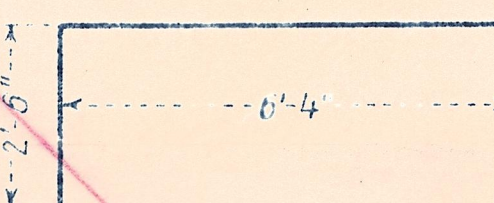

C-BAR

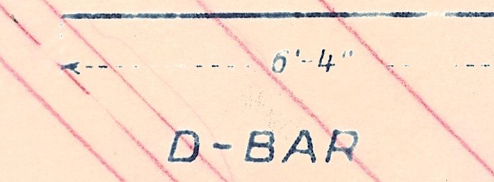

D-BAR

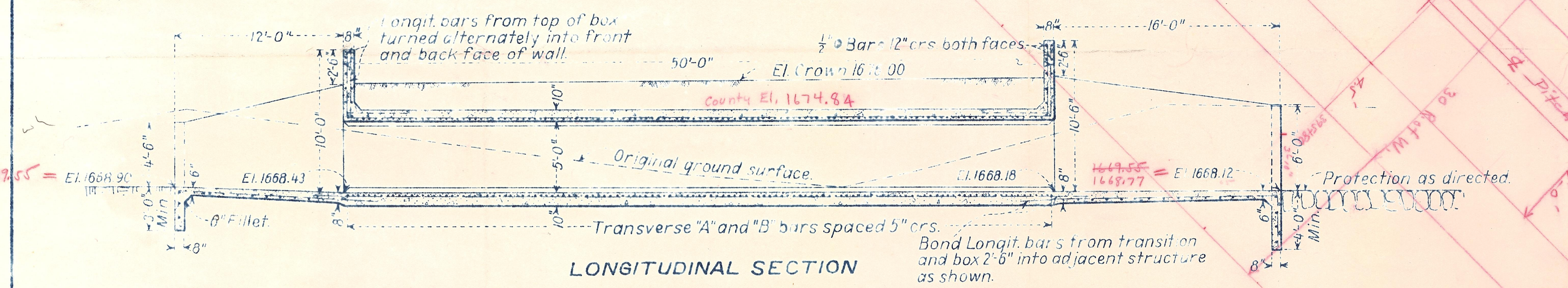

LONGITUDINAL SECTION

ESTIMATED QUANTITIES

Concrete	66.0 Cu.Yds
Reinforcement Steel	7100 Lbs.

NOTES

- Lap all reinforcement bars 40 diameters at splices. Stagger splices.
- All reinforcement shall be placed so that the centers of bars in the outer layer will be 2" from the face of the concrete unless otherwise noted.
- Thickness of slabs to vary uniformly between dimensions shown.

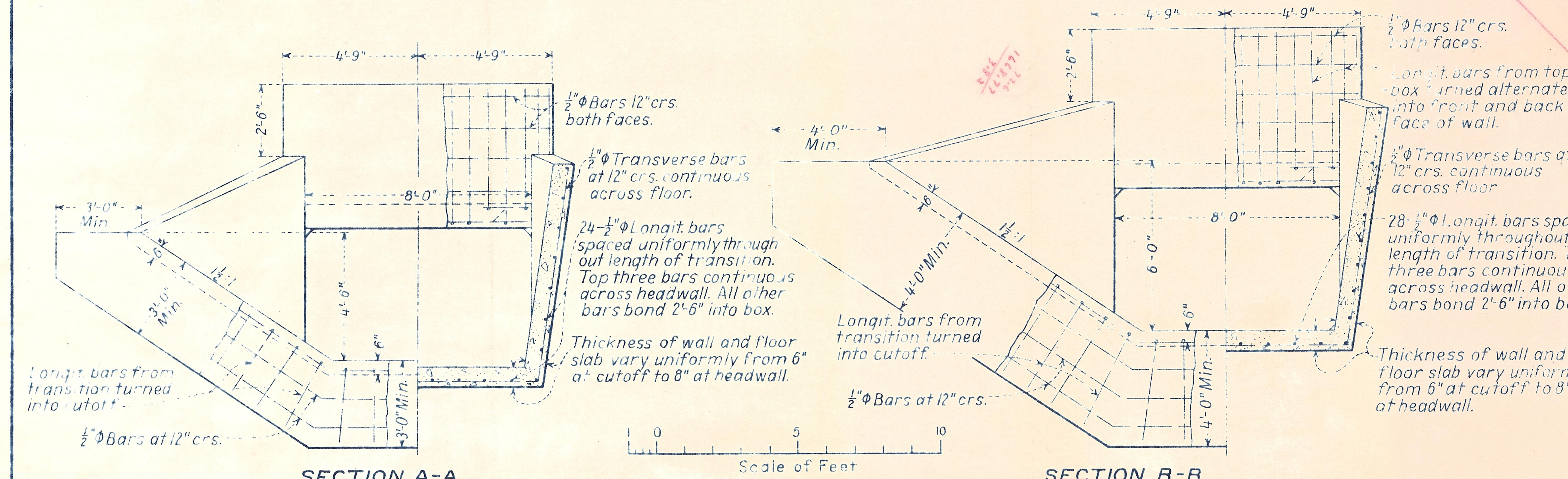

SECTION A-A

SECTION B-B

DEPARTMENT OF THE INTERIOR
BUREAU OF RECLAMATION
YAKIMA PROJECT - WASHINGTON
KITITAS DIVISION

BADGER CREEK WASTEWAY - STA. 107+65.1
HIGHWAY CROSSING
5'x8' CONCRETE BOX CULVERT

DRAWN H.E.M. SUBMITTED *H.R. McBain*
TRACE H.E.E. RECOMMENDED *H. B. Smith*
CHECKED _____ APPROVED *H. B. Smith*

APPROVED FOR COLORADO FEB 13, 1933 **33-D-821**