



TYPICAL SECTION.

SUMMARY OF QUANTITIES

M.P. 0.0 to M.P. 2.70		SECTION 1				2.70 MILES	
MILE	PREPARATION AND FINISHING ROADWAY MILES	MINERAL AGGREGATE IN PLACE FROM STOCK PILE CU. YDS.	M.C.2. ROAD OIL TONS	SPREADING AND FINISHING MILES	WATER IN PLACE M GALS.		
1	1.0	560	25	1.0	40		
2	1.0	560	25	1.0	40		
3(part)	.70	392	17.50	.70	30		
TOTAL	2.70	1512	67.50	2.70	110		

M.P. 0.0 to M.P. 2.25		SECTION 2				2.25 MILES	
MILE	PREPARATION AND FINISHING ROADWAY MILES	MINERAL AGGREGATE IN PLACE FROM STOCK PILE CU. YDS.	M.C.2. ROAD OIL TONS	SPREADING AND FINISHING MILES	WATER IN PLACE M GALS.		
1	1.0	560	25	1.0	40		
2	1.0	560	25	1.0	40		
3(part)	.25	140	6.25	.25	10		
TOTAL	2.25	1260	56.25	2.25	90		

M.P. 0.0 to M.P. 2.50		SECTION 3				2.50 MILES	
MILE	PREPARATION AND FINISHING ROADWAY MILES	MINERAL AGGREGATE IN PLACE FROM STOCK PILE CU. YDS.	M.C.2. ROAD OIL TONS	SPREADING AND FINISHING MILES	WATER IN PLACE M GALS.		
1	1.0	560	25	1.0	40		
2	1.0	560	25	1.0	40		
3(part)	.50	280	12.50	.50	20		
TOTAL	2.50	1400	62.50	2.50	100		

SECTIONS 1, 2 & 3						7.45 MILES	
SECTION	PREPARATION AND FINISHING ROADWAY MILES	MINERAL AGGREGATE IN PLACE FROM STOCK PILE CU. YDS.	M.C.2. ROAD OIL TONS	SPREADING AND FINISHING MILES	WATER IN PLACE M GALS.		
1	2.70	1512	67.50	2.70	110		
2	2.25	1260	56.25	2.25	90		
3	2.50	1400	62.50	2.50	100		
TOTAL	7.45	4172	186.25	7.45	300		

W.P.A.-186.25 TONS ROAD OIL

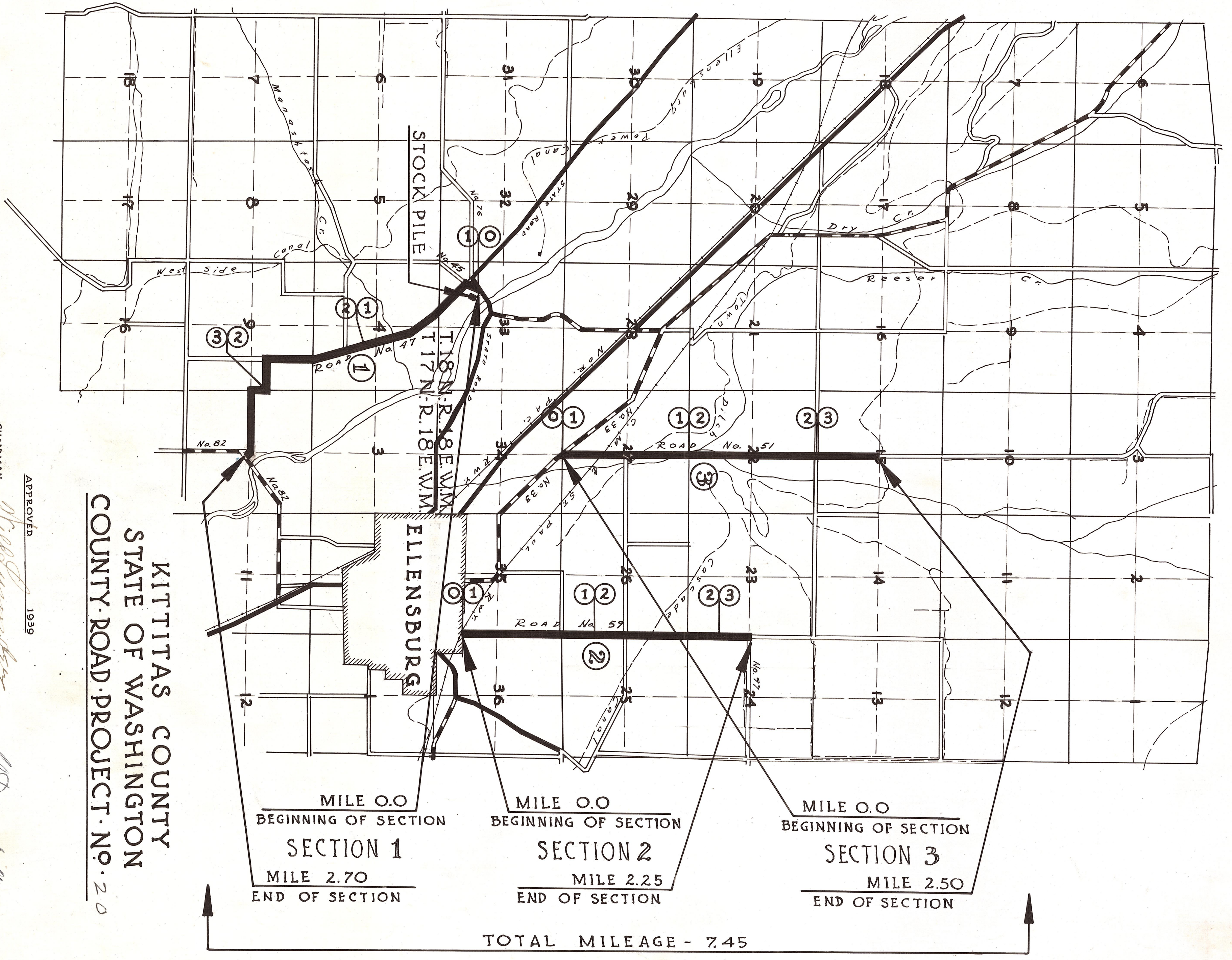

KITTITAS COUNTY
STATE OF WASHINGTON
COUNTY ROAD PROJECT No. 20

APPROVED 1939
CHAIRMAN: [Signature]
MEMBER: [Signature]
MEMBER: [Signature]
BOARD OF COUNTY COMMISSIONERS
COUNTY ROAD ENGINEER: [Signature]