

The Drawings, Specifications and other documents prepared for the Project are the property of the architect. No part of these documents may be reproduced, stored in a retrieval system, or transmitted in any form or by any means, electronic, mechanical, photocopying, recording, or by any information storage and retrieval system, without the prior written permission of the architect. The architect shall be deemed to have accepted the responsibility for the design of the Project and shall not be held responsible for the design of any other project. The architect shall be deemed to have accepted the responsibility for the design of the Project and shall not be held responsible for the design of any other project.

SHEET SIZE
24" x 36"

ARCHITECT
ARCHITECT

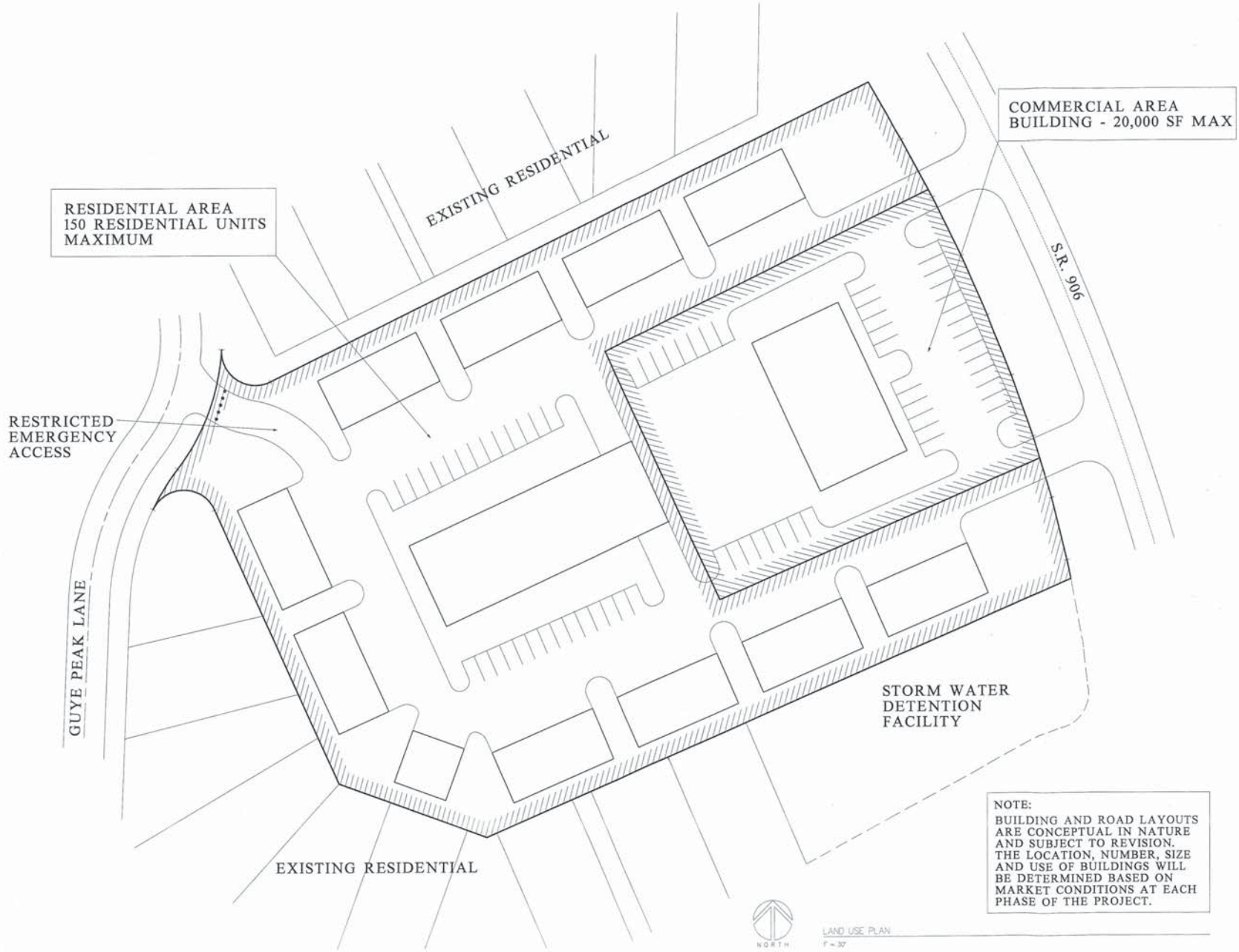

NOTE:
BUILDING AND ROAD LAYOUTS
ARE CONCEPTUAL IN NATURE
AND SUBJECT TO REVISION.
THE LOCATION, NUMBER, SIZE
AND USE OF BUILDINGS WILL
BE DETERMINED BASED ON
MARKET CONDITIONS AT EACH
PHASE OF THE PROJECT.



DAWSON ASSOCIATES
ARCHITECTS / PLANNERS
3000 Parkway Ave. E. Seattle, WA 98108 TEL: 206-325-3877 FAX: 206-325-3882

VILLAGE AT THE SUMMIT, DIV.1 - TRACT E
Kittitas County, Washington
Pass Development, LLC

PROJECT NUMBER 11-014
DRAWN BY CJE
DATE 09.19.11

Land Use Plan

A0.1