

# SITE PLAN

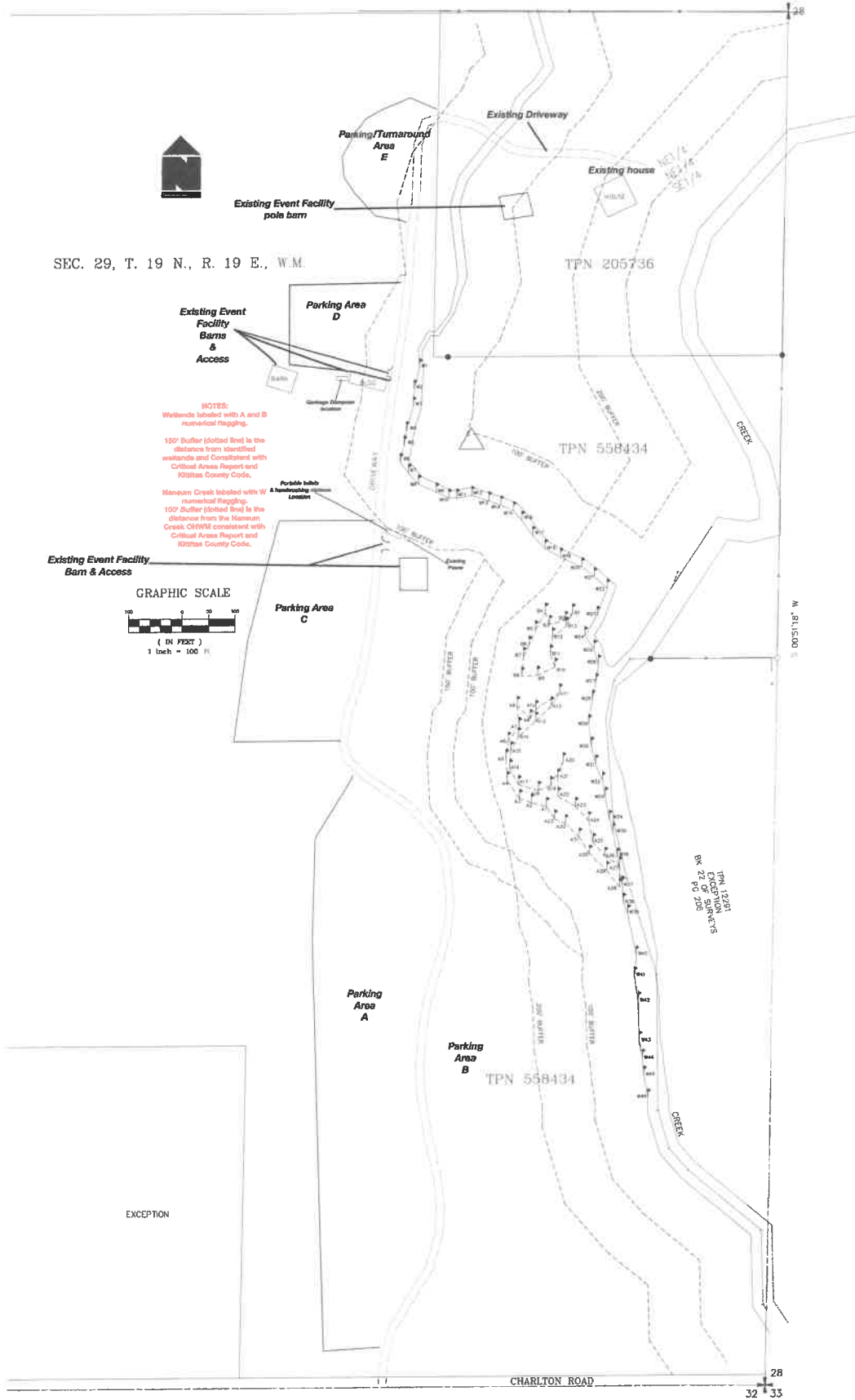

SEC. 29, T. 19 N., R. 19 E., W.M.

TPN 205736

Existing Event Facility Barns & Access

Parking Area D

**NOTES:**  
 Wetlands labeled with A and B numerical flagging.  
 100' Buffer (dotted line) is the distance from identified wetlands and consistent with Critical Areas Report and Kittitas County Code.  
 200' Buffer (dotted line) is the distance from the Manum Creek. CAWMI consistent with Critical Areas Report and Kittitas County Code.

Existing Event Facility Barn & Access

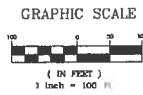

Parking Area C

TPN 558434

TPN 12201  
 EXCISE SURVEYS  
 BK 27 PG 208

Parking Area A

Parking Area B

TPN 558434

EXCEPTION

CHARLTON ROAD

32 33