

Public Notice
Kittitas County, Ellensburg WA

The Board of Kittitas County Commissioners will meet at 2:00 pm on May 3, 2016 at the Commissioners' Auditorium, 205 W. 5th, Room 109, Kittitas County Courthouse, Ellensburg, WA to consider a franchise application by Washington Fruit, a/k/a Selah Ranch LLC for an irrigation franchise along Lawrence Road.

More information is online at <http://www.co.kittitas.wa.us/notices/>.



Clerk of the Board

Publish:

Daily Record: 04/07/16; 04/14/16; 04/28/16

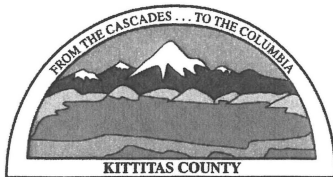

KITTITAS COUNTY DEPARTMENT OF PUBLIC WORKS

411 North Ruby Street, Suite 1, Ellensburg, WA 98926
TEL (509) 962-7523 FAX (509) 962-7663

FRANCHISE APPLICATION

FOR FACILITY IN COUNTY ROAD RIGHT-OF-WAY

Rec # 9495

Fee Schedule

Commercial and Residential Application - Kittitas County Department of Public Works (Non-Refundable): \$750.00

This form precedes the legal agreement set forth by the county when applying for use of road right of way for a franchise facility installation. The legal document is required by Kittitas County Code 12.56 specific to Electrical, Telephone, Natural Gas, Cable TV, Sanitary Sewer, Domestic Water, or Irrigation Water which is designated for commercial use and distribution.

Please type or print clearly in ink. Attach additional sheets as necessary. Pursuant to KCC 15A.03.040, a complete application is determined within 28 days of receipt of the application submittal packet and fee.

Owner/Applicant WASHINGTON FRUIT / SELAH RANCH LLC / NICK PUTH Date 2/10/16
Address 1111 RIVER RD City YAKIMA State WA Zip 98902
Phone 509-654-6768 E-mail nick@washfruit.com

Type of Franchise IRRIGATION
Affected County Road LAWRENCE RD.
Assessor's Parcel No. 16494, 21037

Please provide a brief description below of the proposed franchise:

WE ARE PLANTING AN APPLE ORCHARD IN BADGER POCKET. IN ORDER TO IRRIGATE 10 ACRES IN THE NW CORNER WE NEED TO CROSS LAWRENCE ROAD WITH PVC PIPE.

Kittitas County expects entities applying for use of county maintained right of way specifically address public benefit when applying for franchise and associated right of way use. Please provide a brief description of the public benefit supported by this application (please attach supplement sheet as necessary):

PROVIDING SPRINKLER IRRIGATION TO PARCEL 21037 WILL ALLOW US TO SUCCESSFULLY FARM APPLES AND BRING MORE HONEYCRISP TO THE MARKETPLACE.

Application Received by (PW Staff Signature)

Chader

Date:

02.10.16

Receipt #

9495

Revised on 09/09/2016

✓ #84170

Crop: Honeycrisp Apples on ___ft x 10ft row Spacing
 Sprinklers: R10-P6-9 0.75FC on 36ft x 20ft Tria. Spacing
 Poly Laterals @ 5.5ft Elevation with 1" Entry Ball Valve



Contour Interval: 10FT

Power Requirements
 Years 1/3 Gravity Lat.: 50HP
 Years 3+ Gravity Lat.: 50HP + 100HP + 100HP
 Pumped Lat.: 20HP Pumped Lat.: 20HP + 100HP

BRIGATION SPECIALISTS
 815 Wallace Way, Groveview, Wv. 26030 T. 509-882-2000

WFP RODEO Ranch

Blocks & UT-OT System

Designed by: Jon Hayter, CID

Date: Revised 1/12/2016

Pipe key

- 12" Class 125 IFS GSK PVC Pipe
- 12" Class 100 IFS GSK PVC Pipe
- 58" Polyethylene Tubing (18mm)
- 34" Polyethylene Tubing (21mm)
- 34" Class 200 IFS SW PVC Pipe
- 1" Polyethylene Tubing (30mm)
- 1" Class 200 IFS SW PVC Pipe
- 1 1/4" Polyethylene Tubing (35mm)
- 1 1/4" Class 125 IFS SW PVC Pipe
- 1 1/2" Class 125 IFS SW PVC Pipe
- 2" Class 125 IFS SW PVC Pipe
- 2 1/2" Class 125 IFS SW PVC Pipe
- 3" Class 125 IFS SW PVC Pipe
- 4" Schedule 40 SW PVC Pipe
- 4" Class 125 IFS SW PVC Pipe
- 5" Class 125 IFS SW PVC Pipe
- 6" Class 100 IFS GSK PVC Pipe
- 8" Class 100 IFS GSK PVC Pipe
- 10" Class 100 IFS GSK PVC Pipe

Sprinkler / Valve key

#TEXT#

Scale: 1" = 160' File: WFP Rodeo Ranch U

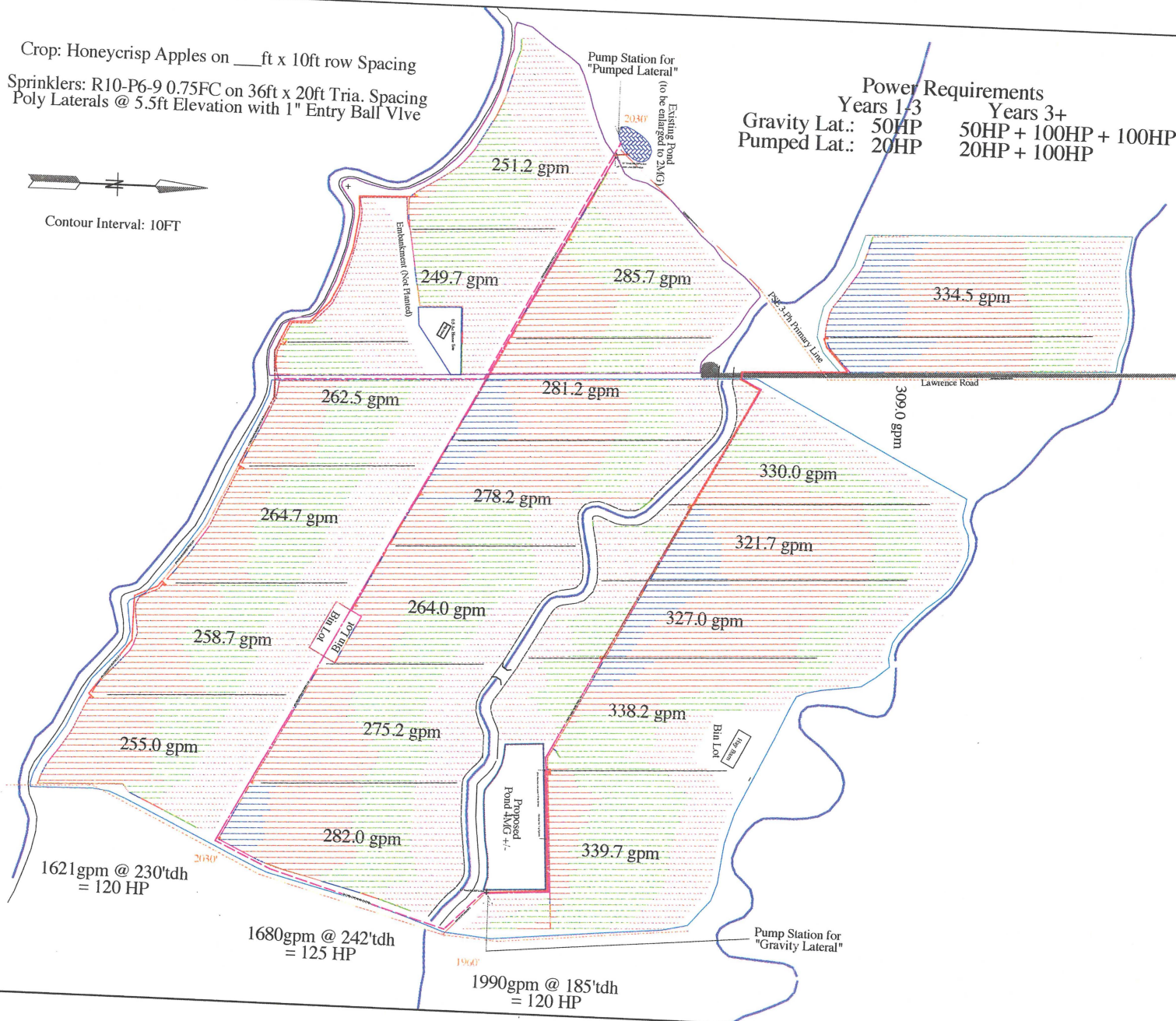

HAROLD RD

IRRIGATION FRANCHISE FOR WASHINGTON FRUIT, SELAH RANCH LLC, ETC

LAWRENCE RD

MOOLA RD

PARCEL 21037

PARCEL 16494

Legend

