

SECTION C-C  
SCALE 1/4"=10'

THIS WEDGE IS TO BE USED IN DECK SECTIONS TO MAKE FISH-MOUTH NOTCHES IN LEG OF SECTION

CENTER 2'5" FROM NORTH END  
26'5" CENTER TO CENTER  
CENTER 1'6" FROM SOUTH END

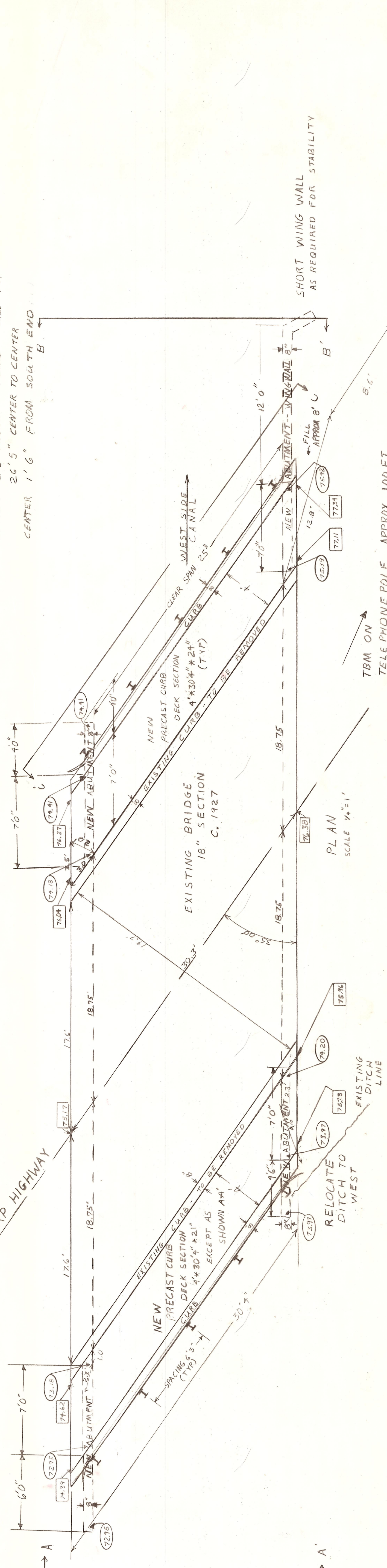

PLAN  
SCALE 1/4"=1'

WING WALLS TO BE REMOVED & ABUTMENTS EXTENDED AS REQUIRED. FINISH SEAT ELEVATIONS SHOWN IN  $\text{\textcircled{O}}$ .

FINISH GRADE ELEVATIONS SHOWN IN  $\text{\textcircled{H}}$ .

APPROX 10 C.Y. FOR ABUTMENTS AND WALLS

SECTION A-A'  
SCALE 1/4"=10'

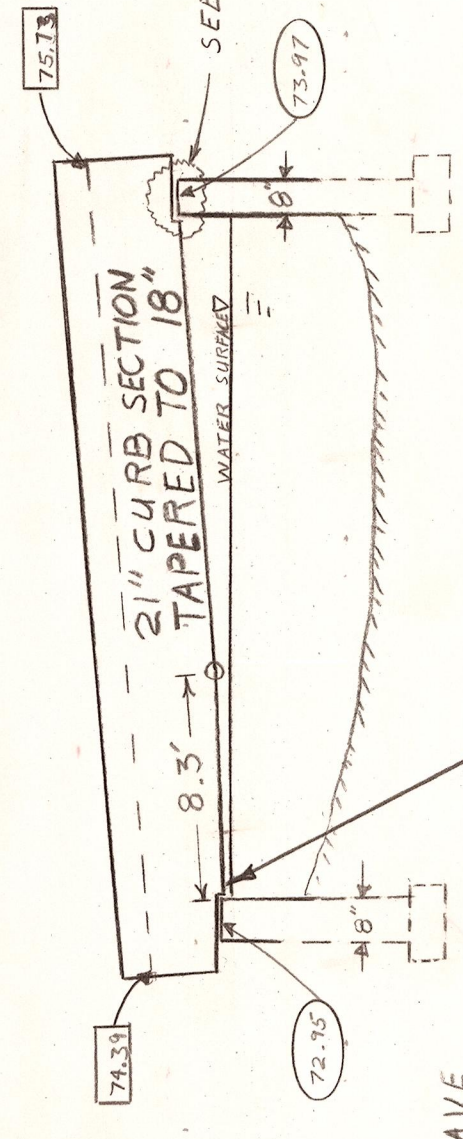

SHOULD LEAVE ABOUT 0' FREEBOARD AT NEW NW CORNER.

SECTION B-B'  
SCALE 1/4"=10'

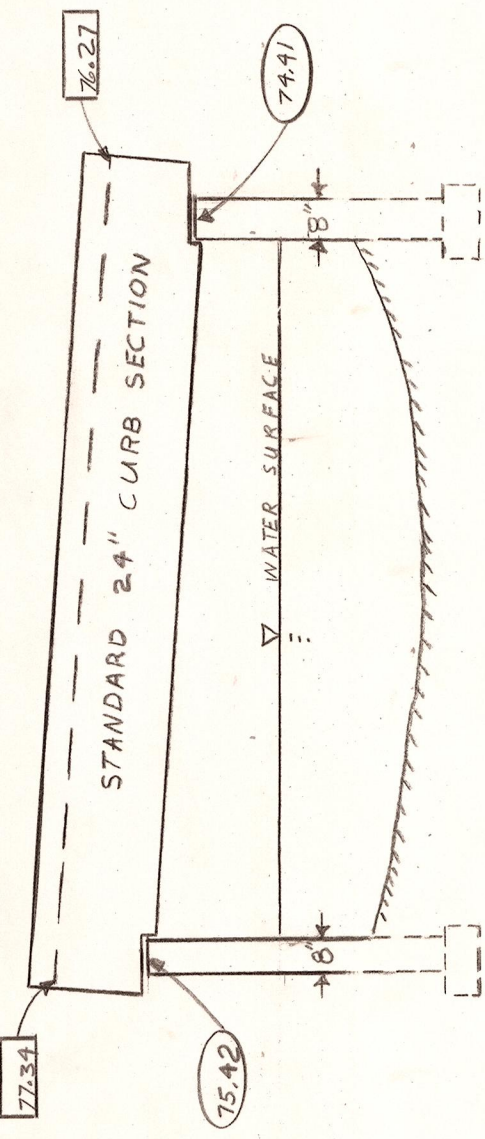

OFFICE OF COUNTY ROAD ENGINEER  
**KITTITAS COUNTY**  
ELLENSBURG, WASHINGTON  
THORP HIGHWAY BRIDGE #87131  
WESTSIDE CANAL

SCALE:  $\frac{H}{V}$  AS SHOWN CRP  
DRAWN BY DJL DATE MARCH 1974 SHEET 1 OF 1  
APPROVED: 7/23/74 *Stanley C. Blomgren* COUNTY ROAD ENGINEER  
DATE

DATE	ELEVATION-W/SIDE	BY
MAY 74		