

**INDEX**

Sheet No. 1 - Title & layout  
 " 2 - Summary of Quantities Plan & Prof. (By) Prof.  
 S.S.H. No. 3-M & Circuit Wiring Diagram (S.M. & M.S.)  
 N.P. Ry. Crossing Signals  
 S.D. Highway R.R. Advanced Warning Sign.  
 Std. Reflectors for R.R. Advanced Warning Sign.

**WASHINGTON STATE HIGHWAY COMMISSION**  
**DEPARTMENT OF HIGHWAYS**  
 OLYMPIA, WASHINGTON  
**SECONDARY STATE HIGHWAY NO. 3-M**  
**THORP VICINITY**  
**N.P. RY. CROSSING SIGNALS**  
**FEDERAL AID ROUTE NO. 273**  
 KITITAS COUNTY  
**FEDERAL AID SECONDARY PROJECT NO. SG-0273(1)**

**LAYOUT**

GROSS LENGTH	0.00	MILES
EXCEPTION	0.00	MILES
NET LENGTH	0.00	MILES

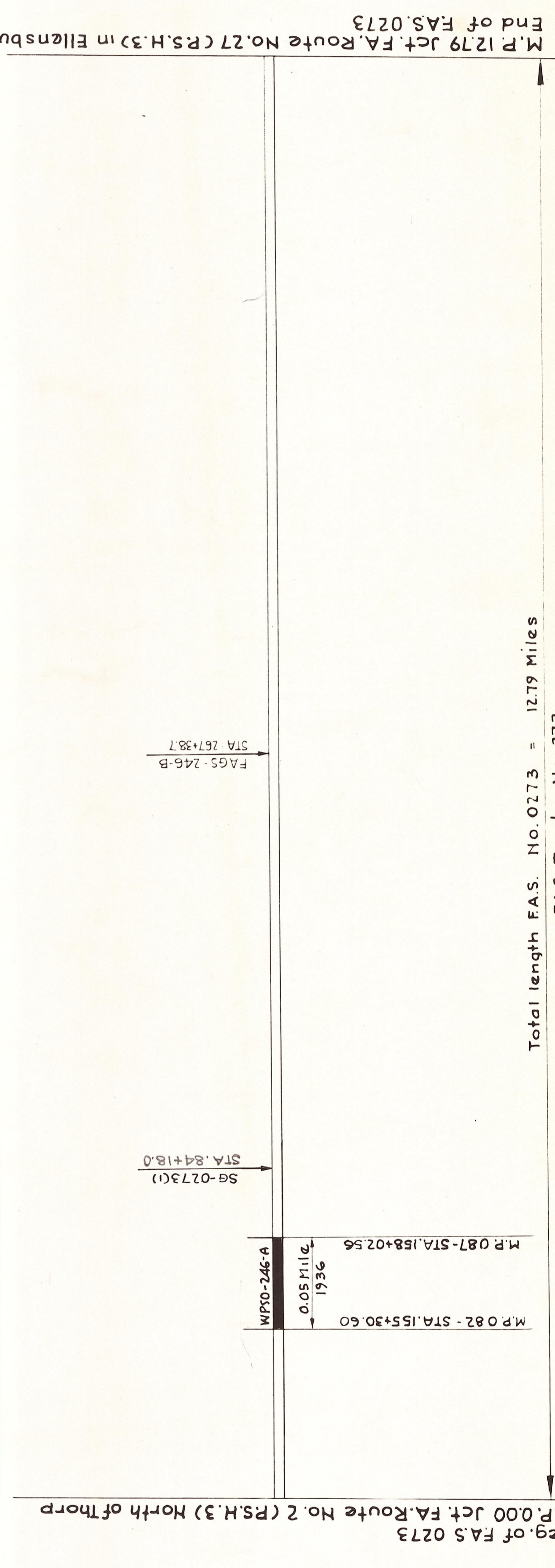
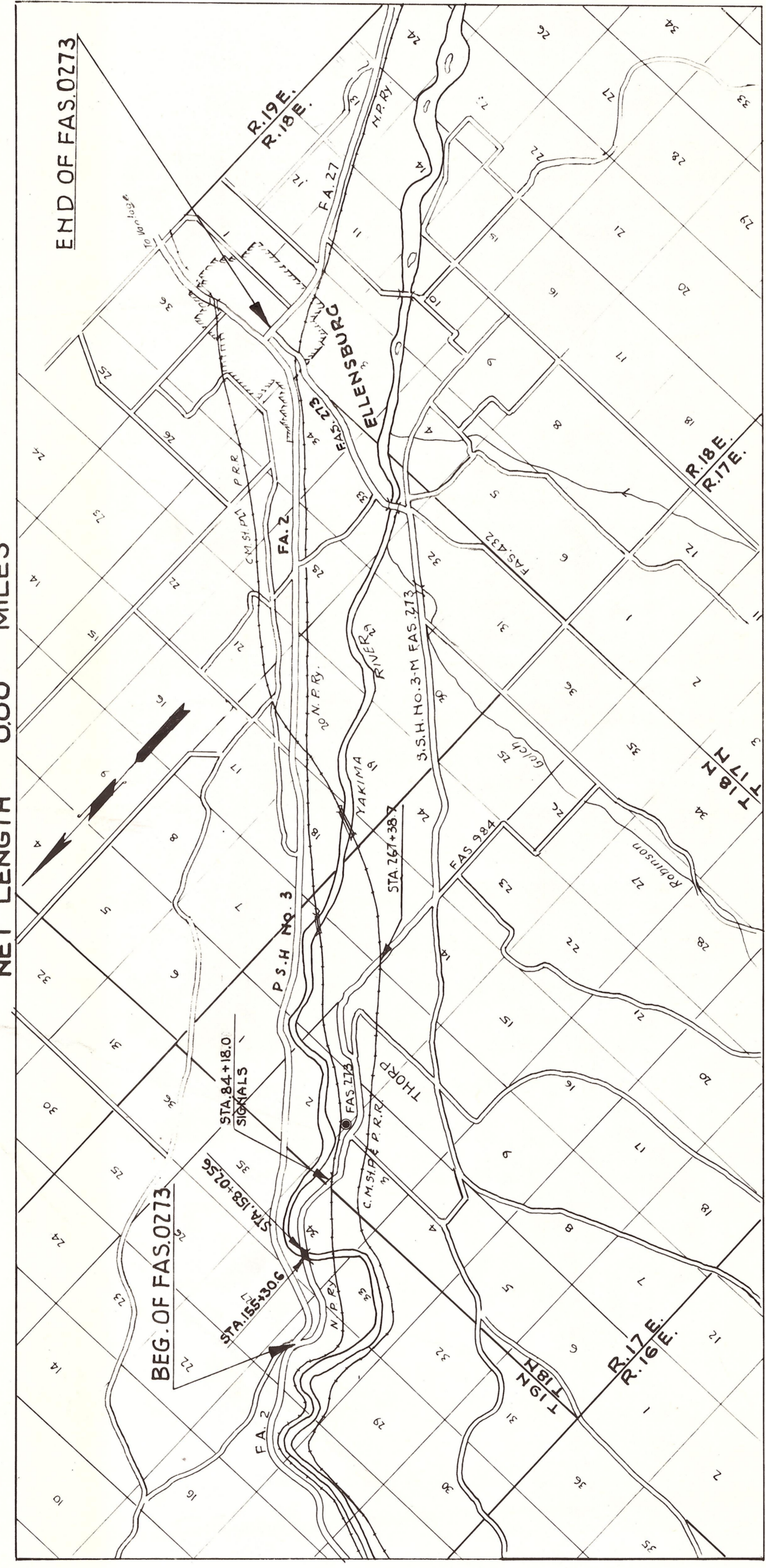

Total length F.A.S. No. 0273 = 12.79 Miles  
 F.A.S. Route No. 273

FED. ROAD DIV. NO.	STATE	FED. AID PROJ. NO.	FISCAL YEAR	SHEET NOS.	TOTAL SHEETS
8	WASH.	SG-0273(0)		1	2

**CONVENTIONAL SIGNS**

- STATE OR NATIONAL LINE
- COUNTY LINE
- CITY OR TOWN LINE
- TOWNSHIP LINE
- SECTION LINE
- 1/4 LINE
- 1/8 LINE
- GRANT LINE
- FENCE LINE
- UNFENCED PROPERTY
- BASE OF SURVEY LINE
- RIGHT OF WAY LINE
- TRAVELED WAY
- RAILROAD
- EXISTING CULVERT
- PROPOSED CULVERT
- GUARD RAIL
- RETAINING WALL
- POWER POLES
- TELEPHONE OR TELEGRAPH POLES
- GOVERNMENT MEANDER LINE
- MARSH

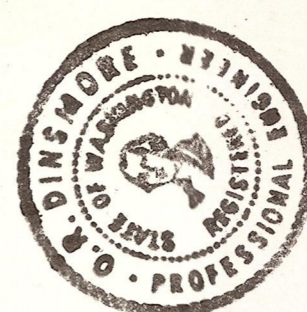

Approved Feb. 18, 1952  
*D. Dinsmore*  
 Asst. Director of Highways

DEPARTMENT OF COMMERCE BUREAU OF PUBLIC ROADS	
RECOMMENDED FOR APPROVAL:	
DISTRICT ENGINEER	DATE
APPROVED:	
DIVISION ENGINEER	DATE

CONT. A168  
 3-M  
 12

FOUR ROAD DIST. NO.	0	DATE	5-27-50	PROJECT	2	SHEET NO.	2
---------------------	---	------	---------	---------	---	-----------	---

PROFILE PLAN OF N.P.R.Y.  
ELEVATION TO TOP OF RAIL = 1678.58  
SCALE: HORIZONTAL 1"=100'  
VERTICAL 1"=10'

Sta. 7179+31.0 = HWY. STA. 84+15

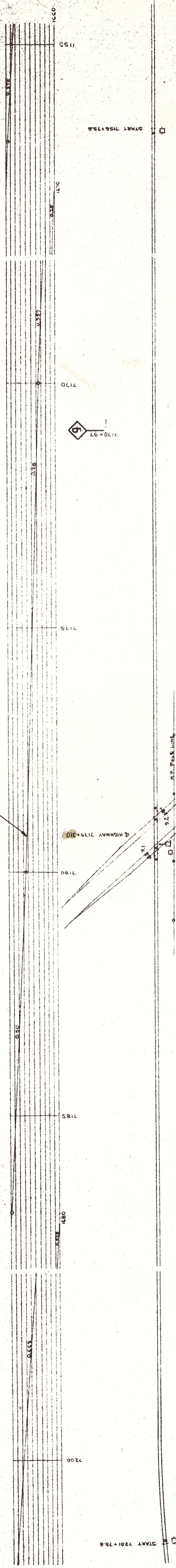

76	77	78	79	80	81	82	83	84	85	86	87	88	89	90	91	92
1655	1655	1655	1655	1655	1655	1655	1655	1655	1655	1655	1655	1655	1655	1655	1655	1655

HIGHWAY STA 84+15 ELEV. 1678.58  
 HIGHWAY TOP OF RAIL ELEV. 1678.58  
 RY. TOP OF RAIL ELEV. 1678.58 (RY. DATUM)

PROFILE OF S.S.H. NO. 3-M  
SCALE: HORIZ 1"=200'  
VERT 1"=20'

NOTE: Ry. Datum is 1266 Above Highway Datum.

**SUMMARY OF QUANTITIES**  
**2-ONLY HIGHWAY CROSSING SIGNALS-AUTOMATIC FLASHING LIGHTS**  
**WITH ILLUMINATED STOP SIGNS**

SECONDARY STATE HIGHWAY NO. 3-M

THORP VICINITY

N.P. RY. CROSSING SIGNALS

KITITAS COUNTY

WASHINGTON STATE HIGHWAY COMMISSION  
DEPARTMENT OF HIGHWAYS  
OLYMPIA, WASHINGTON

SCALE: AS SHOWN  
APPROVED: FEB. 18, 1952

ASST. DIRECTOR OF HIGHWAY

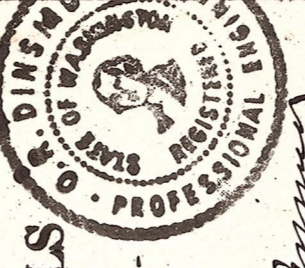

SHEET 1 OF 1 SHEETS  
CONTRACT NUMBER 4168

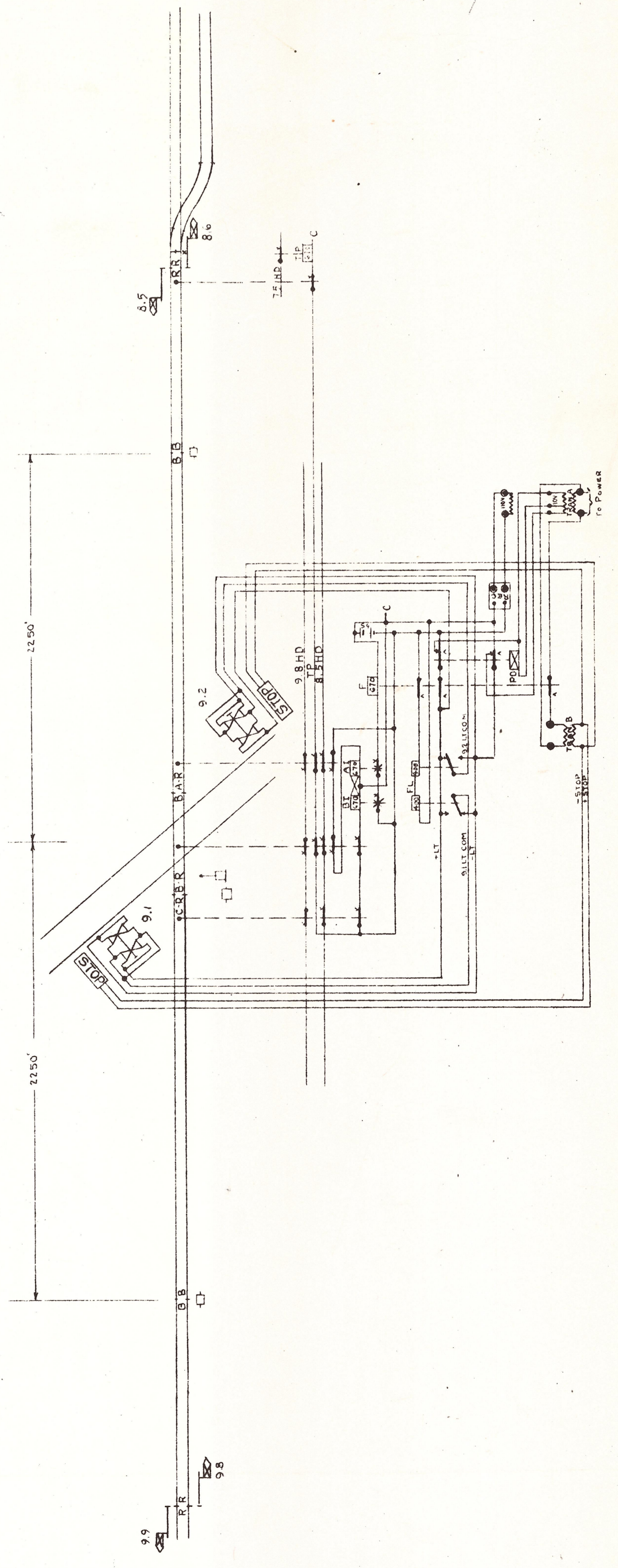

N.P.R.Y.  
CROSSING AT MP 9+827  
TACOMA DIV, MAIN LINE, 1ST SUB DIV  
THORP, WASH.  
SCALE: 1"=20'  
12-13-51