

T. 21N. R. 14E. W.M.

A 6° 50'  
 P.T. 410.41  
 P.T. 344.21  
 P.C. 580.20  
 P.T. 642.53

A 7° 16'  
 P.T. 60.62  
 P.C. 94.81  
 P.T. 111.11  
 P.T. 170.84

A 1° 36'  
 P.T. 127.83  
 P.T. 120.23  
 L.C. 243.33  
 P.T. 140.57

A 12° 45'  
 P.T. 10.45  
 P.C. 45.45  
 L.C. 90.90  
 P.T. 151.80

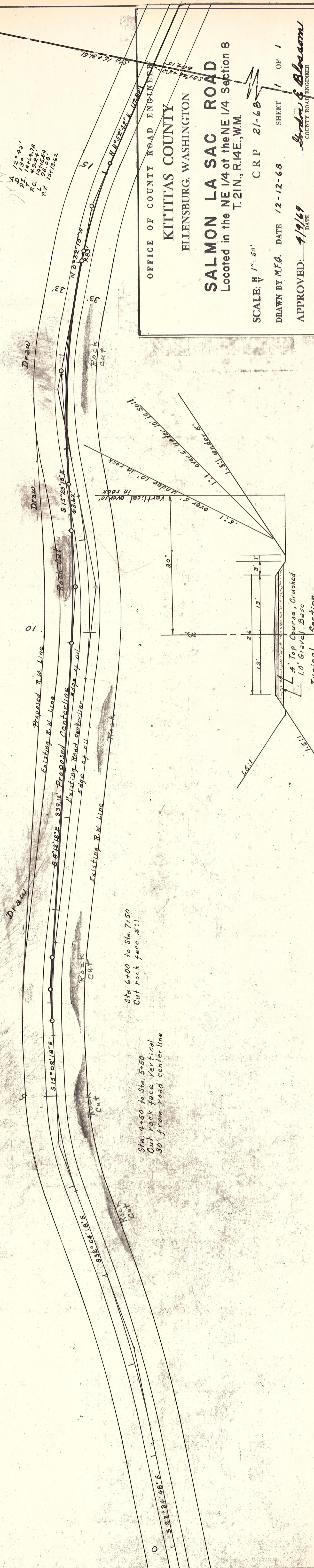

Sta. 450 to Sta. 550  
 Cut rock face Vertical  
 30' from road centerline

Sta. 600 to Sta. 7150  
 Cut rock face 5:1

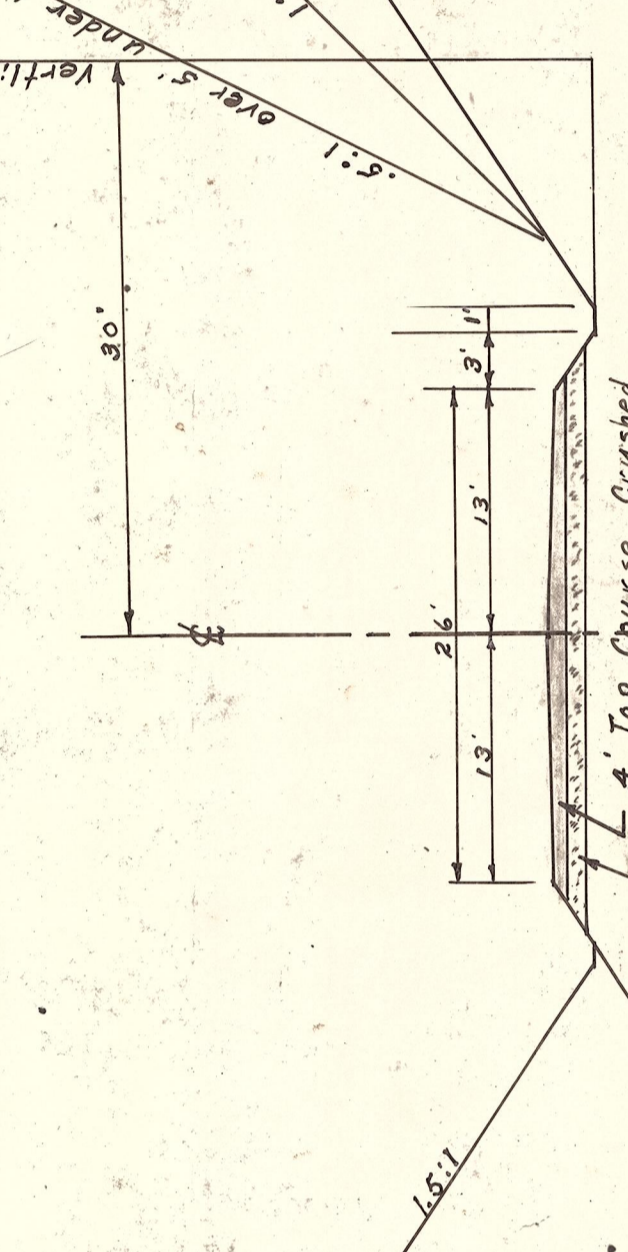

OFFICE OF COUNTY ROAD ENGINEER  
 KITTITAS COUNTY  
 ELLENSBURG, WASHINGTON

**SALMON LA SAC ROAD**  
 Located in the NE 1/4 of the NE 1/4 Section 8  
 T. 21N., R. 14E., W.M.

SCALE:  $\frac{1}{4}$ " = 50' CRP 21-68

DRAWN BY M.F.G. DATE 12-12-68 SHEET 1 OF 1

APPROVED: *John S. Blouman*  
 COUNTY ROAD ENGINEER

