

T. 16 N. R. 20 E. N. M.

AGNES SOBETSON  
17 1/2 N. 1/4  
Sec. 6

U. S.  
17 1/2 S. 1/4  
Sec. 6

N. P. Rwy. Co.  
E. 1/4 S.E. 1/4  
Sec. 6

T. 17 N. R. 20 E. N. M.

STA. 96+80.1  
BEGINNING OF  
EXTENSION

STA. 153+11.7  
END  
OF EXTENSION

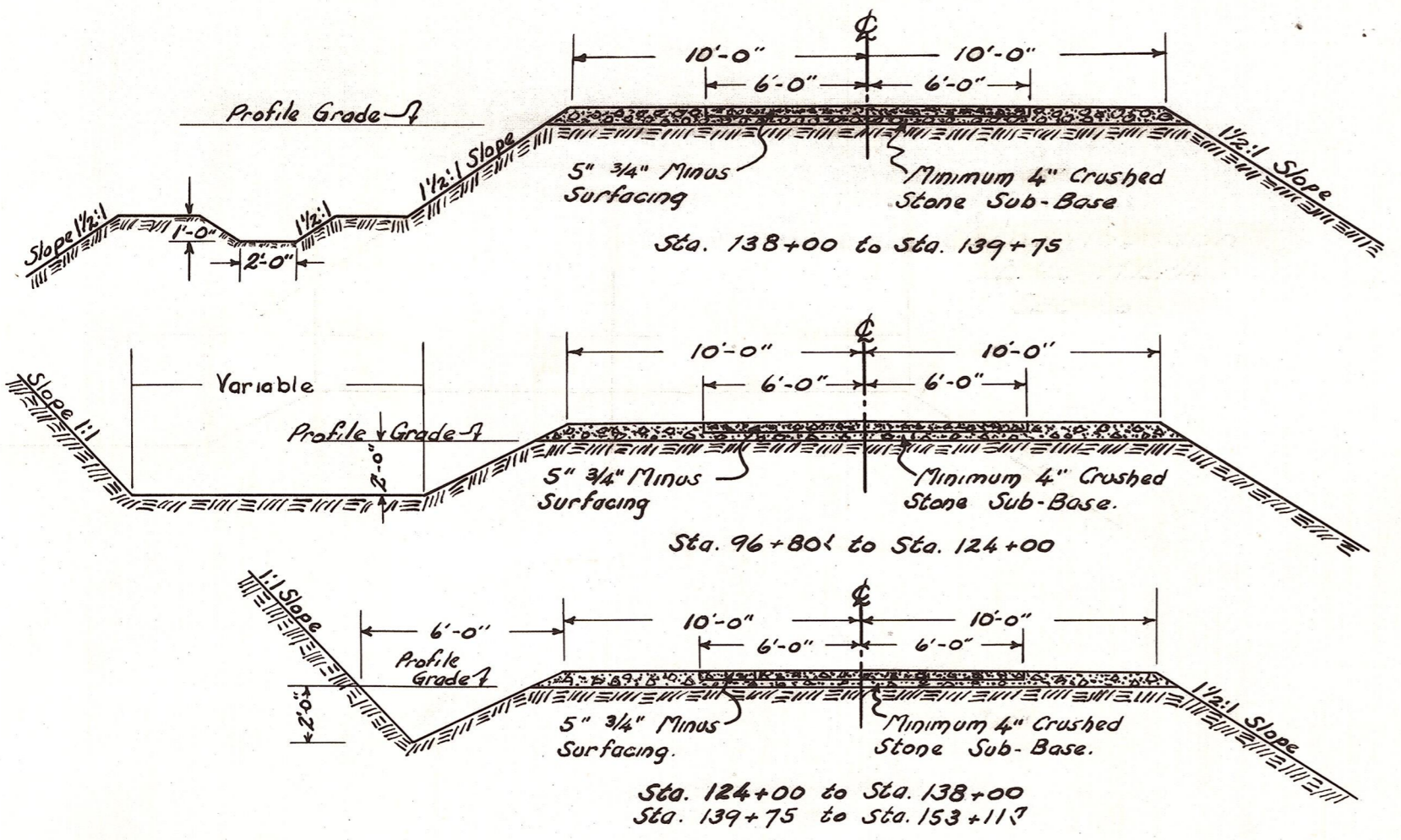
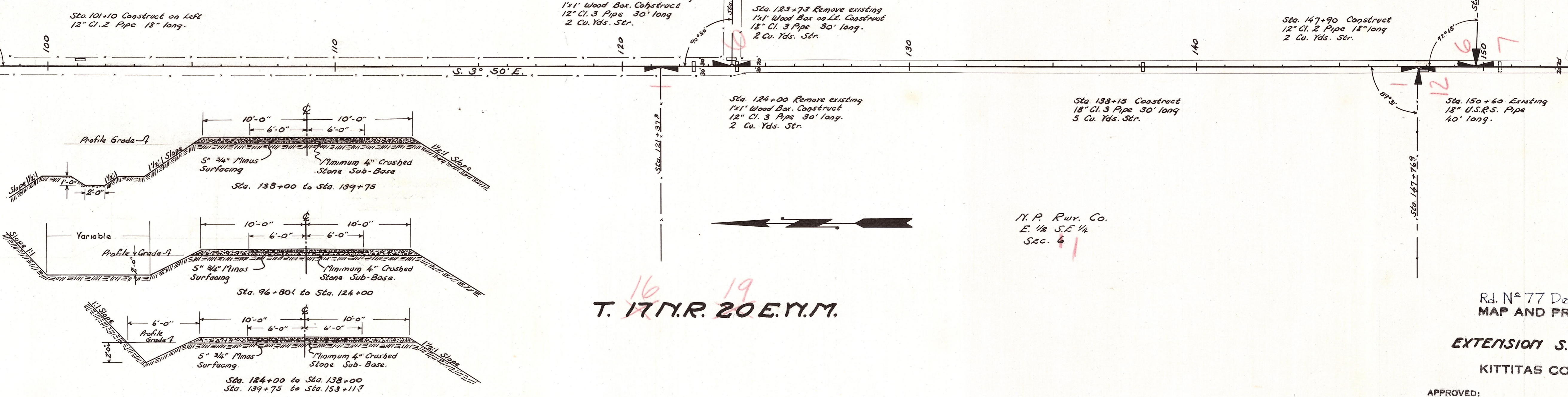

TYPICAL SECTIONS

Rd. No. 77 Denmark  
MAP AND PROFILE  
EXTENSION S.R.P. No. 11-A  
KITTITAS COUNTY

APPROVED:  
SCALE: HORIZ. ONE IN. = 200 FT. VERT. ONE IN. = 20 FT.  
SHEET 1 OF 1 SHEETS W. T. BOWMAN Co. Engr.

SUMMARY OF QUANTITIES							
EXCAVATION	SURFACING	OVERHAUL		CLASS 2 PIPE		CLASS 3 PIPE	
		SUB BASE	TOP COURSE	12"	18"	12"	18"
CLASS A' STRUCT.	Cu. Yds.	Cu. Yds.	Cu. Yds.	Yd. Sta.	Lin. Ft.	Lin. Ft.	Lin. Ft.
5590	13	2085	1080	800	36	60	60

