

NOTES

- NOTE 1: INSTALL NEW BRIDGE GUARDRAIL POSTS TYPE 2, 5 EACH TO BE SPACED 6'-3" FROM EXISTING POST
- NOTE 2: EXISTING POST LOCATION TO BE REPLACED WITH NEW BRIDGE GUARDRAIL POSTS TYPE 2, 7 EACH AT EXISTING LOCATIONS.
- NOTE 3: INSTALL NEW BRIDGE GUARDRAIL POSTS TYPE 2, 2 EACH LOCATED SYMMETRICALLY ABOUT CENTER OF SPAN.
- NOTE 4: INSTALL NEW BRIDGE GUARDRAIL POSTS TYPE 2, 5 EACH SPACED AT 6'-3" WITH 1ST. POST 8' FROM WEST END OF CURB.

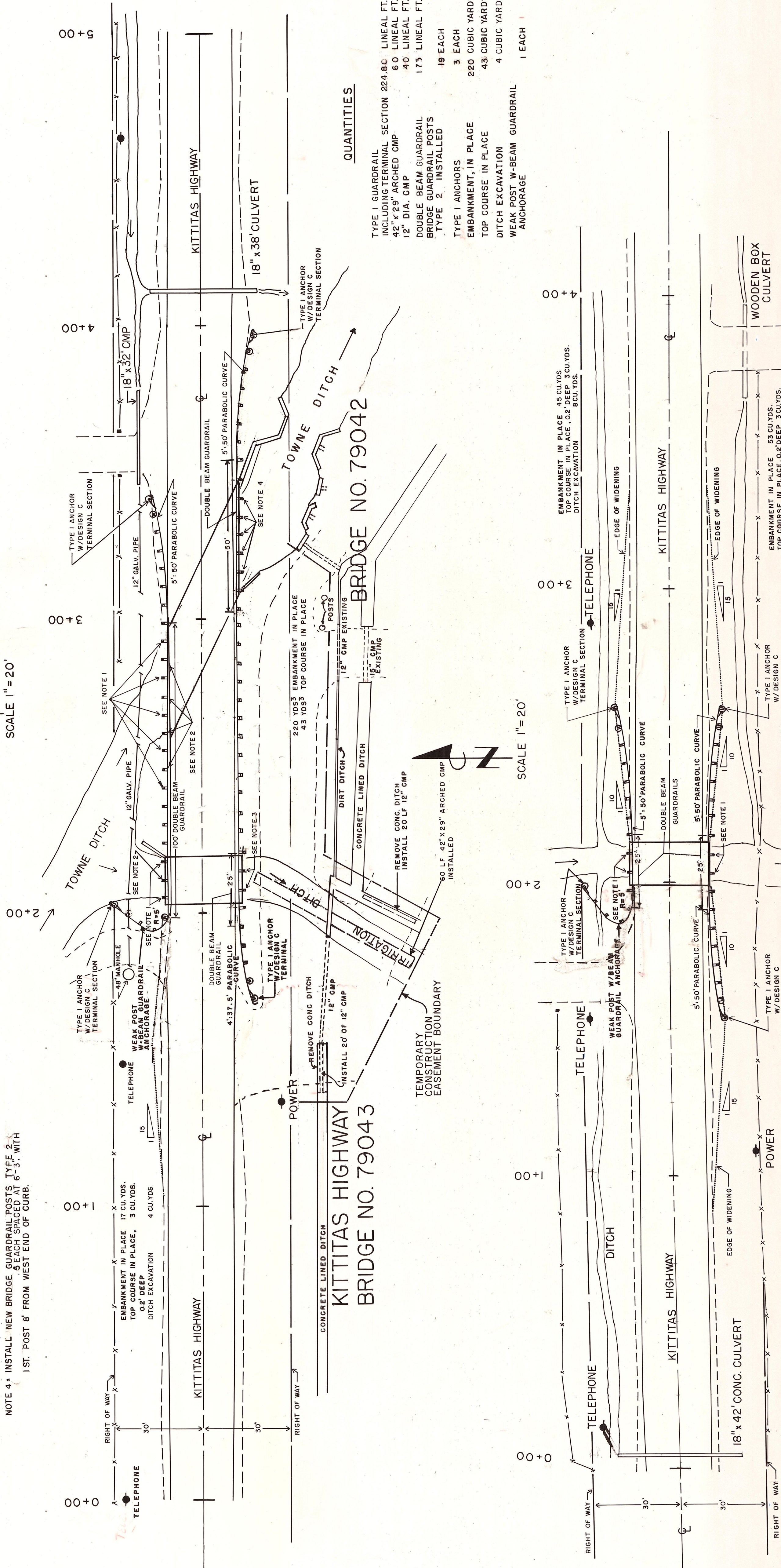

QUANTITIES

TYPE 1 GUARDRAIL INCLUDING TERMINAL SECTION	224.80	LINEAL FT.
42" x 29" ARCHED CMP	60	LINEAL FT.
12" DIA. CMP	40	LINEAL FT.
DOUBLE BEAM GUARDRAIL BRIDGE GUARDRAIL POSTS TYPE 2	175	LINEAL FT.
TYPE 2	19	EACH
TYPE 1 ANCHORS	3	EACH
EMBANKMENT, IN PLACE	220	CUBIC YARDS
TOP COURSE IN PLACE	43	CUBIC YARDS
DITCH EXCAVATION	4	CUBIC YARDS
WEAK POST W-BEAM GUARDRAIL ANCHORAGE	1	EACH

NOTES

- NOTE 1: INSTALL 4 EACH BRIDGE GUARDRAIL POSTS, TYPE 2 SEE PAGE 31. SPECIAL PROVISIONS: POSTS TO BE LOCATED 2 PER SIDE SYMMETRICALLY ABOUT CENTER OF SPAN.

QUANTITIES

TYPE 1 GUARDRAIL INCLUDING TERMINAL SECTION	156	LINEAL FT.
DOUBLE BEAM GUARDRAIL	50	LINEAL FT.
TYPE 1 ANCHOR	3	EACH
EMBANKMENT IN PLACE	134	CUBIC YARDS
TOP COURSE IN PLACE	9	CUBIC YARDS
DITCH EXCAVATION	16	CUBIC YARDS
BRIDGE GUARDRAIL POSTS TYPE 2	4	EACH
WEAK POST W-BEAM GUARDRAIL ANCHORAGE	1	EACH

KITTITAS HIGHWAY BRIDGE NO. 79044

FOR GUARDRAIL POST & BLOCK TYPE 2 - SEE SHEET 4 of 14

QUANTITIES

EMBANKMENT IN PLACE	45	CUBIC YARDS
TOP COURSE IN PLACE	0.2	DEEP 3 CUBIC YARDS
DITCH EXCAVATION	8	CUBIC YARDS
EMBANKMENT IN PLACE	53	CUBIC YARDS
TOP COURSE IN PLACE	0.2	DEEP 3 CUBIC YARDS
DITCH EXCAVATION	8	CUBIC YARDS

DEPT. OF PUBLIC WORKS
KITTITAS COUNTY
 ELLENSBURG, WASHINGTON
 KITTITAS HIGHWAY BRIDGE ETAL.
 APPROACH GUARDRAILS
 SCALE: H¹" = 20'
 DRAWN BY DLT DATE SEPT. 1981 SHEET 6 OF 14
 APPROVED: *[Signature]* DATE *4/27/83* DIRECTOR OF PUBLIC WORKS

