

T 16 N R 20 EWM
SEC. 23

Owner:
Kenneth J. Cadwallader
Rt. 2 Bx. 284
Ellensburg, Wa.

Sta. 1+65
Existing Approach &
15' x 48' CMP

Sta. 3+40
Install 18" x 14' (±) CMP

STA. 2+00
BEGINNING OF PROJECT

Owner:
Joe Hobbs
Rt. 2 Bx. 885
Ellensburg, Wa.

TBM EL. 100.00
SPIKE IN BASE

STA 3+45 EXISTING TIMBER BRIDGE
TO BE REMOVED & REPLACED WITH
75' x 112' x 40' ARCH CULVERT

INSTALL STOCK PANEL OVER
OUTLET OF ARCH PIPE 1x6 MATL.

T 16 N R 20 EWM
SEC. 22

STA. 4+50
END OF PROJECT

PLAN	
DATE	BY
REVISIONS	
NO.	NOTE BOOK
	ALIGNMENT CHECKED
	RT. OF WAY CHECKED
	DATE

PROFILE	
DATE	BY
REVISIONS	
NO.	NOTE BOOK
	GRADES CHECKED
	STRUCTURE NOTATIONS CHECKED
	DATE

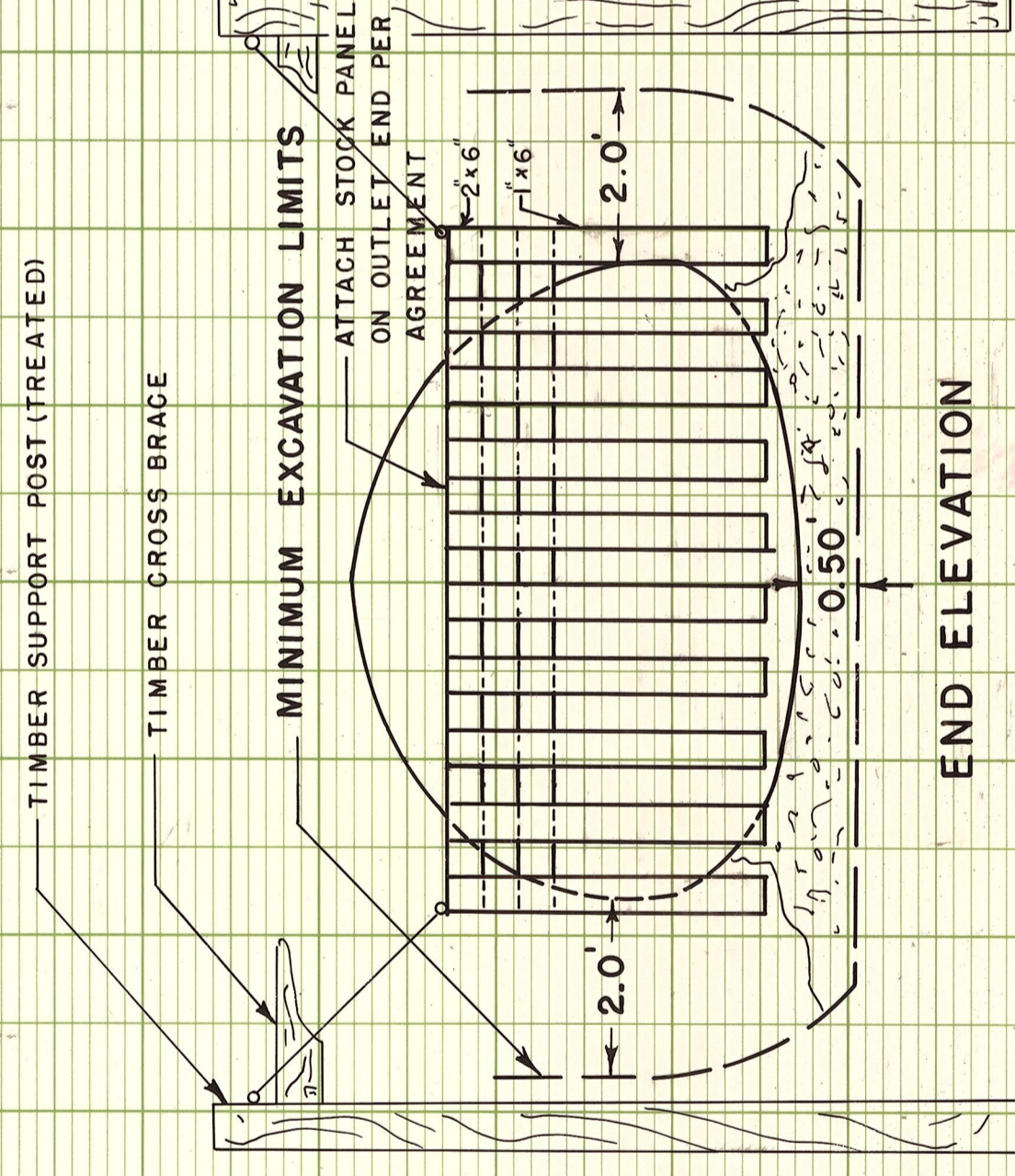
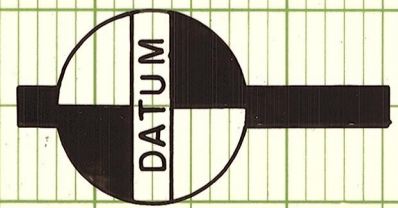
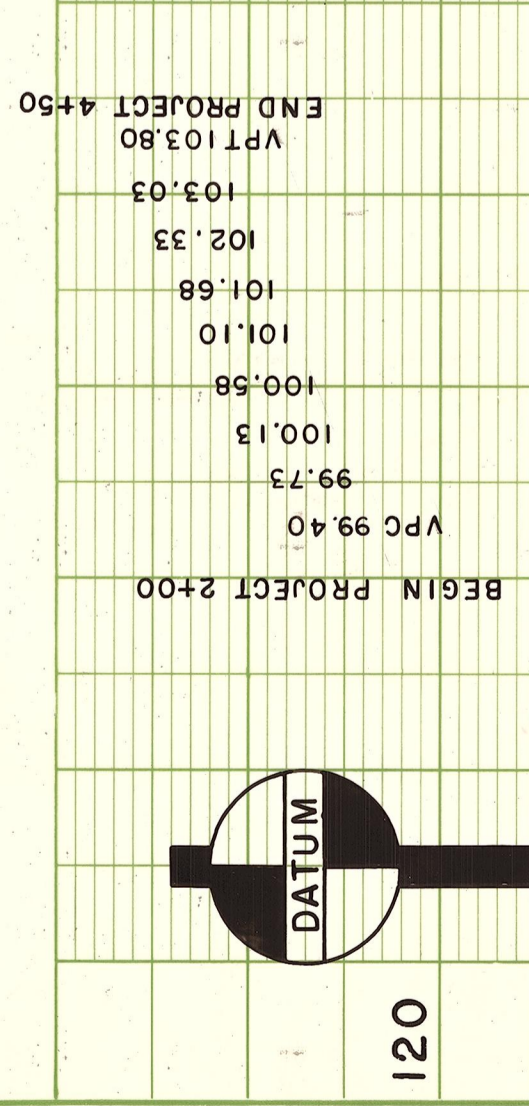

Note: Existing Wood Bridge to be Removed (60231)

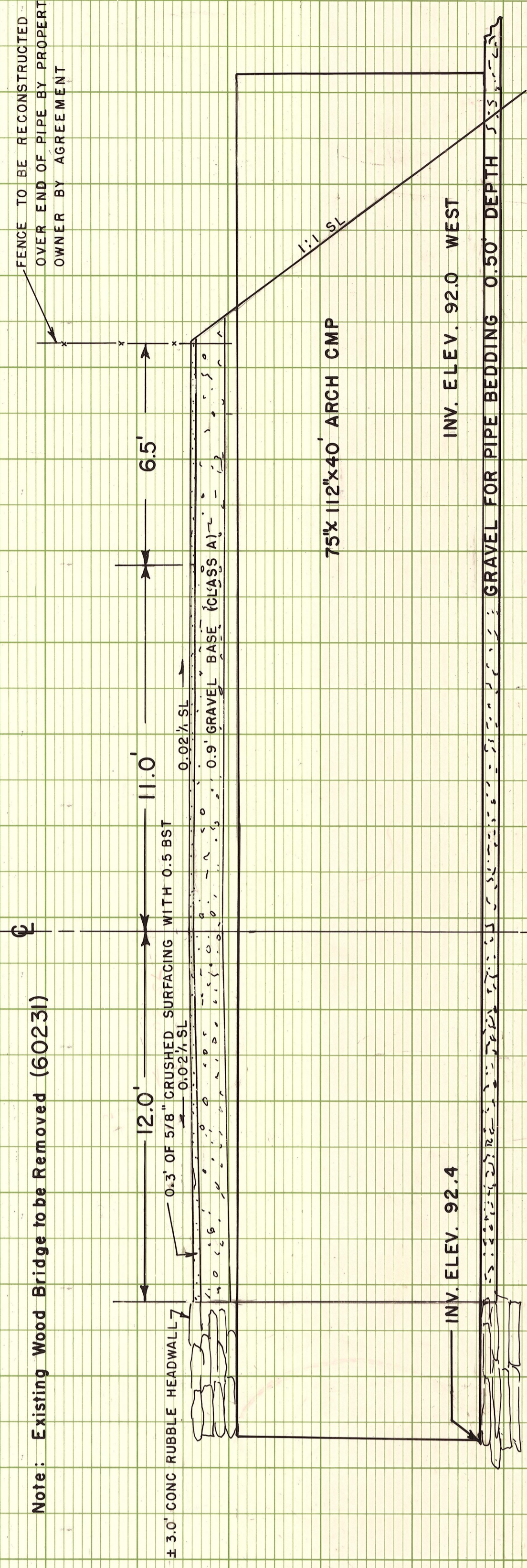

SECTION A-A
NO SCALE

KITTITAS COUNTY DEPARTMENT OF PUBLIC WORKS
KITTITAS COUNTY
ELLENSBURG, WASHINGTON
S. INDERMUHLE RD.

SCALE: H 1" = 20'
V 1" = 10'

DRAWN BY DML DATE 2-3-82 SHEET 1 OF 1

APPROVED: 3/82 DATE *[Signature]* DIRECTOR OF PUBLIC WORKS

