

DATE	BY	REVISIONS
		1. REVISED
		2. PLOTTED
		3. GRADES CHECKED
		4. R.M. NOTED
		5. STRUCTURE NOTATIONS CHECKED

DATE	BY	REVISIONS
		1. REVISED
		2. PLOTTED
		3. GRADES CHECKED
		4. R.M. NOTED
		5. STRUCTURE NOTATIONS CHECKED

DEPARTMENT OF PUBLIC WORKS  
**KITTITAS COUNTY**  
 ELLENSBURG, WASHINGTON  
 SQUAW CREEK TRAIL  
 BRIDGE NO. 79091 (TOWNE DITCH)

SCALE: H: V 1"=10' CRP  
 DRAWN BY J.N. DATE February 10, 1986 SHEET 1 OF 2  
 APPROVED: \_\_\_\_\_ DATE \_\_\_\_\_ DIRECTOR OF PUBLIC WORKS

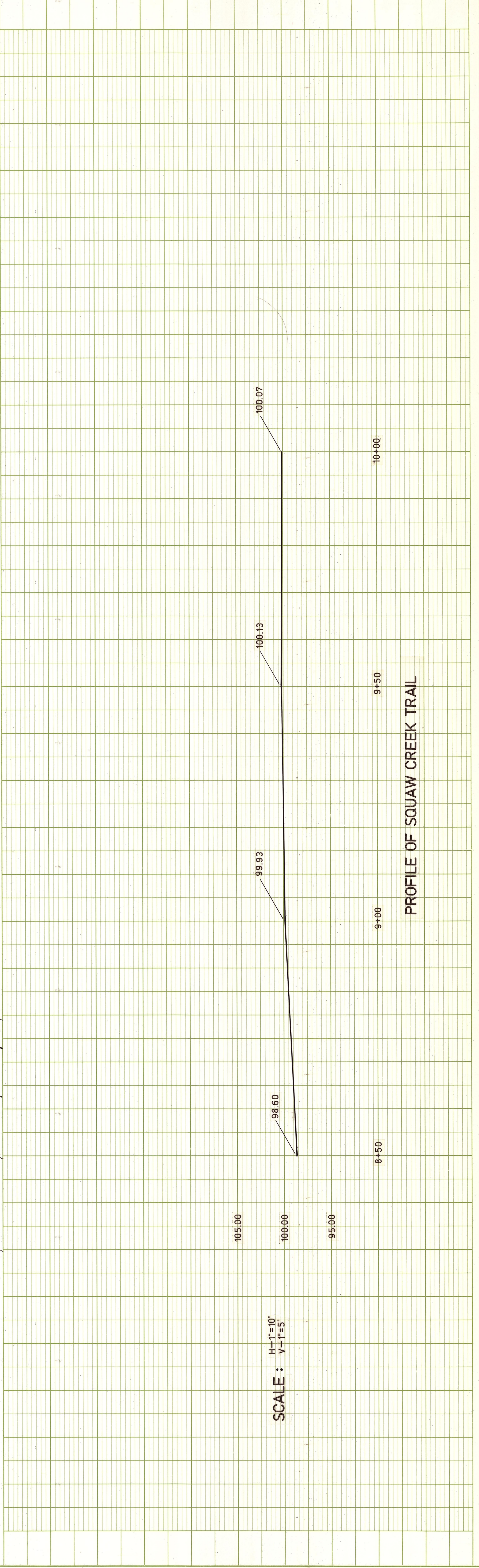
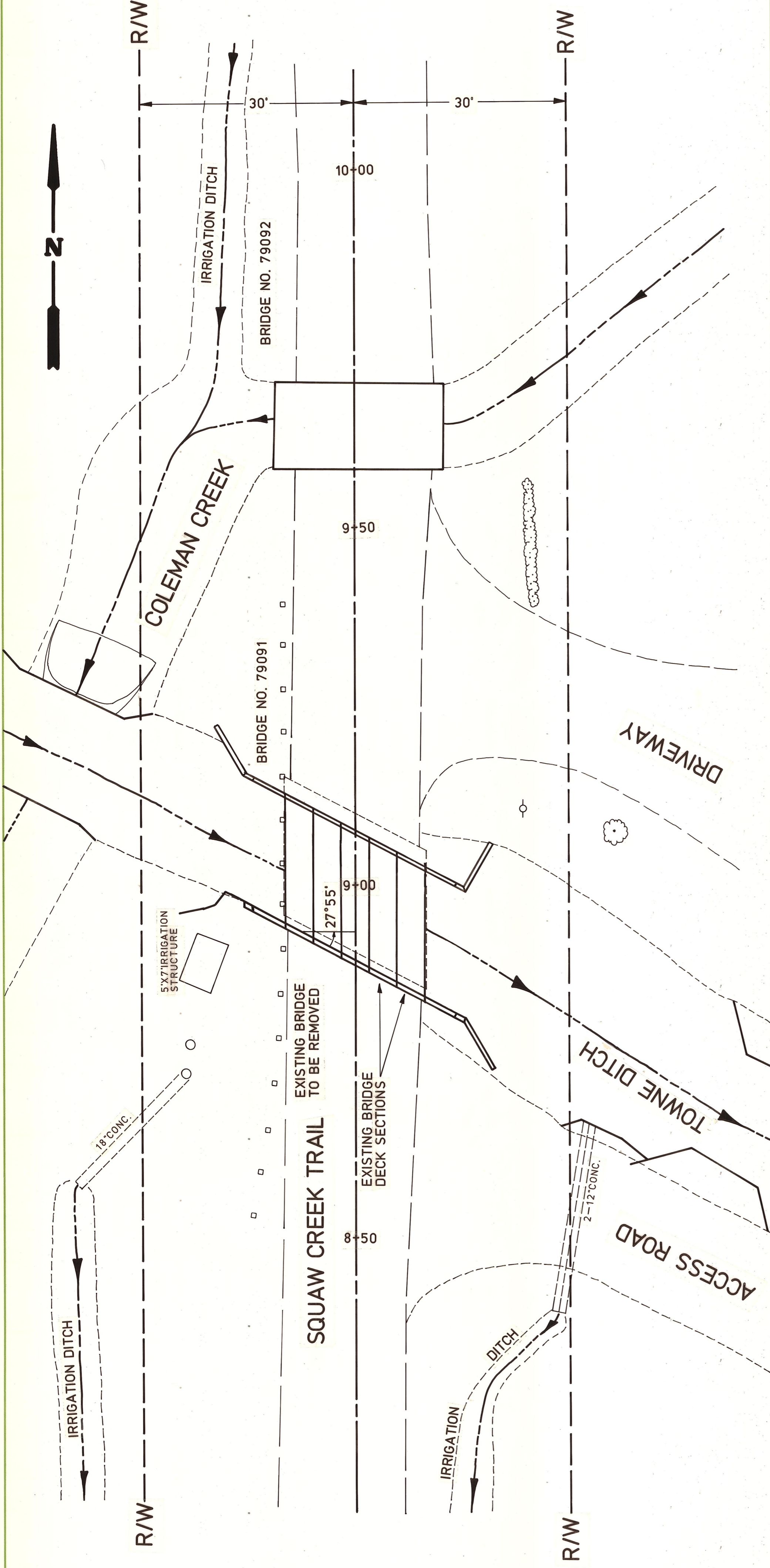

SCALE: H=1"=10' V=1"=5'

PROFILE OF SQUAW CREEK TRAIL

DEPARTMENT OF PUBLIC WORKS

**KITTITAS COUNTY**  
**ELLENSBURG, WASHINGTON**  
**SQUAW CREEK TRAIL**  
BRIDGE NO. 79091 (TOWNE DITCH)

SCALE:  $\frac{H}{V}$  VARIOUS **CRP**  
DRAWN BY J.N. DATE February 25, 1986 SHEET 2 OF 2  
APPROVED: \_\_\_\_\_ DATE \_\_\_\_\_ DIRECTOR OF PUBLIC WORKS

