



ABATE OF WASHINGTON

To Whom It May Concern,

My Name is Lyle Coyle, I am the committee chair for ABATE of Washington's Spring Opener held last year in Easton at the Silver Ridge Ranch. We are hoping that you will allow us to do this event there again this year. I have filled out the permit and given all information that I could think of however if I have not given you the information you need please contact me and I will get whatever information you need. My e-mail address is lacoy@live.com and cell # 253-617-8843.

Sincerely

Lyle Coyle

RECEIVED

NOV 18 2011

1st ____ 2nd ____ 3rd ____
KITITAS COUNTY BOARD OF COMMISSIONERS

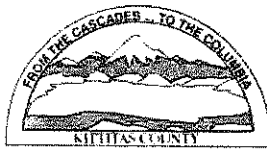

Kittitas County, Washington

BOARD OF COUNTY COMMISSIONERS

EVENT APPLICATION

Thank you for your interest in holding a special event in Kittitas County. Please complete and return this application along with any other materials to the Kittitas County Board of Commissioners **at least 60 days** prior to the day upon the event is scheduled. Any misrepresentation in the application materials or deviation from the final agreed upon route and/or method of operation described may result in the immediate revocation of an issued permit. Specifics outlining Event Permits can be viewed at <http://www.co.kittitas.wa.us/boc/countycode/title05.asp>

Event Information

Name of event: ABATE of Washington Spring Opener

Date(s) of event: June 14-17 2012

Hours of operation: 6:00 AM - 1:00 AM

Description of the event: A weekend event of music, motorcycle games,

Has this event taken place before? ☒ Yes ☐ No Dates: last 32 years same weekend

Estimated attendance: 500 to 1500

How is your event being publicized? newsletter, flyers (are not made up till event is definite)

Please attach any flyers, posters, etc. with your application submission.

Contact Information

Name of the organizer/contact person: ABATE of Washington/Mick Gillispie

Address: P.O. Box 8369, Tacoma, WA. 98419-0369

Phone number(s): 253-475-4944 home - 253-381-6724 cell

Email address: abatemember@comcast.net / please cc lacoy@live.com

Date of birth of applicant: March 21, 1979

If the application is made on behalf of a partnership, please submit full names with their residence and post office address for a period of six months prior to the date of application together with the location of principal office or place of business of such corporation. Corporation (see attached)

Mick Gillispie - State Coordinator 253-381-6724

Emergency contact name(s) and phone number(s) that can be contacted during the event:

Ron Voss - officer

509-305-1363

Name

Phone Number

Lyle Coyle

253-617-8843

Name

Phone Number

WRITTEN PERMISSION TO ENTER EVENT SITE

I/We hereby permit law enforcement and/or County officials to enter the site for which the Event Application has been granted at the time of the event and up to five days prior to the event for the purposes of inspecting and enforcement of County Code and other applicable laws, and pursuant to my agreement and representations made in connection with this Event Application.

SWORN STATEMENT OF COMPLIANCE

I/We hereby acknowledge that I/We have read Kittitas County Code, have familiarized myself with County requirements. I/We agree that either my designated agent or I/we shall be on site at all times and shall be responsible for the operation of the event and for compliance with all legal requirements in connection with this event.

I/We understand that failure to comply with the rules, regulations and conditions set forth in Code may be deemed a gross misdemeanor and that drug or narcotics violations are crimes under RCW.

ABATE of Washington State Coordinator
Applicant Name (Print)

Mick Gillispie
Applicant Signature

ABATE of Washington Deputy Coordinator
Applicant Name (Print)

Ronald E. Voss
Applicant Signature

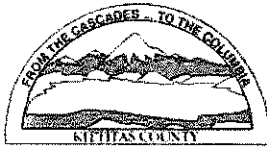

Kittitas County, Washington

BOARD OF COUNTY COMMISSIONERS

Fire Safety and Protection

If more than 50 people are expected at your event, you must complete a separate application process which can be obtained through the Kittitas County Fire Marshal's office. You may contact the Fire Marshal's office at 509-962-7000.

Will there be a temporary structure erected for the event? Yes ☒ No

If yes, you must attach a drawing including the dimensions. The structure may require an inspection by County staff prior to the event.

Public Health/Environmental Health

Will there be food served at the event? ☒ Yes No

If no food will be served at the event then, no permit or application is required.

If yes, is the food and beverage that you intend on preparing and serving at the event exempt from permit requirements <http://www.co.kittitas.wa.us/health/food.asp>?

- If yes, please submit an application for exemption from permit and proof of food handlers training to the Kittitas County Public Health Department (KCPHD).

If yes, and the food or beverage is not considered exempt from permit, then does the person or organization preparing and serving the food have a food service permit, temporary food service permit, or catering permit from KCPHD?

- If yes, please provide a list of foods and beverages that you intend on having prepared and served at the event along with the name and phone number(s) of the permitted person or organization.

If yes, and the person or organization preparing and serving the food does not already have a food service permit.

- Then a temporary food service permit or catering permit will need to be acquired from KCPHD prior to the event.

Please allow at least 2 weeks to complete the food service permitting process.

Are there permanent or fixed bathroom facilities already available at the location of the event?

☒ Yes

☐ No

If yes, please provide an estimated attendance for the event, a detailed map that identifies the name and address of the physical facility that will provide lavatory facilities for the event, quantity of toilette facilities available for each gender, and the distance from the event that patrons must walk.

If no, please provide an estimated attendance for the event, specific information related to the number of portable restrooms that will be provided, the distance from the event that patrons must walk, and a service plan to ensure that sani-cans remain in a sanitary condition. You must include the location of the portable restrooms on a map/diagram of the event.

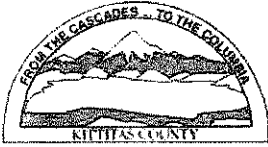

Kittitas County, Washington

BOARD OF COUNTY COMMISSIONERS

Law Enforcement/Security/Emergency Medical Services

Will there be security on site during the event? ☒ Yes ☐ No

If yes, please provide a complete list of names and contact information for who will be providing the security.

Will Emergency Medical Services (EMS) be on site during the event? ☒ Yes ☐ No

If yes, please provide written verification from the providers.

Will there be music, sound amplification or any other noise impacts? ☒ Yes ☐ No

If yes, Kittitas County has a noise ordinance in effect (see County Code for details). If your event is scheduled for outside of the allowed time, you must submit a written letter to the Board of County Commissioners requesting a waiver and it must be included with your application materials.

Will you have traffic control? Yes ☒ No

If yes, please provide documentation on how the traffic control will be addressed.

Will there be off-site parking? Yes ☒ No

If yes, please provide the location and a parking plan.

Will there be shuttle buses provided for attendees? Yes ☒ No

If yes, provide a map of their route.

Will there be alcohol served at the event? Yes ☒ No

If yes, a State permit is required from the WA State Liquor Control Board and must be submitted with your application materials.



Kittitas County, Washington

BOARD OF COUNTY COMMISSIONERS

Public Roads

Will the event obstruct, interfere or require the closure and free use of any public road, street or right-of-way? Yes ☒ No

If yes, please provide a detailed adequate traffic and detour plans at the time of submission of the application.

Will there need to be road closure or detour signs posted? Yes ☒ No

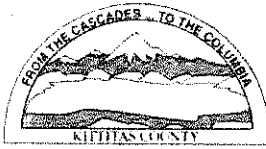

Kittitas County, Washington

BOARD OF COUNTY COMMISSIONERS

Garbage/Recycling

Do you have a plan for garbage and recycling? ☒ Yes ☐ No

A written plan for garbage and recycling must be attached to your application materials. For questions or assistance contact the Kittitas County Solid Waste Department at 509-962-7542.

Insurance

Have you obtained a Certificate of Insurance, specifically naming "Kittitas County" as an insured? ☒ Yes ☐ No

A copy of the Certificate of Insurance must be included with your application materials. Kittitas County must be named as an additional insured in the amount of \$1,000,000.00 per occurrence and \$2,000,000.00 aggregate coverage.

Penal Bond - Bond of Indemnity

A \$5,000.00 Penal Bond - Bond of Indemnity is required to be deposited with the County Treasurer to save and protect the streets, pavements, bridges, etc. from damage. The deposit or its balance will be returned once the event has been held and the Board of County Commissioners has certified no damage has been done and that the County has not incurred additional expenses

Are you submitting a \$5,000.00 Penal Bond - Bond of Indemnity with your Event Application? ☐ Yes ☒ No

If no, you must request a letter in writing to the Board of County Commissioners requesting a waiver to the Penal Bond - Bond of Indemnity and outline the specific reasons why it should not be required of your event.

County Filings and Registration

Is there a cost to attend the event? ☒ Yes ☐ No

How much are you charging to attend your event? \$35.00 / \$40.00



CERTIFICATE OF LIABILITY INSURANCE

ABATE-1

OP ID: CL

DATE (MM/DD/YYYY)

10/27/11

THIS CERTIFICATE IS ISSUED AS A MATTER OF INFORMATION ONLY AND CONFERS NO RIGHTS UPON THE CERTIFICATE HOLDER. THIS CERTIFICATE DOES NOT AFFIRMATIVELY OR NEGATIVELY AMEND, EXTEND OR ALTER THE COVERAGE AFFORDED BY THE POLICIES BELOW. THIS CERTIFICATE OF INSURANCE DOES NOT CONSTITUTE A CONTRACT BETWEEN THE ISSUING INSURER(S), AUTHORIZED REPRESENTATIVE OR PRODUCER, AND THE CERTIFICATE HOLDER.

IMPORTANT: If the certificate holder is an **ADDITIONAL INSURED**, the policy(ies) must be endorsed. If **SUBROGATION IS WAIVED**, subject to the terms and conditions of the policy, certain policies may require an endorsement. A statement on this certificate does not confer rights to the certificate holder in lieu of such endorsement(s).

PRODUCER Century Insurance Services LLC 3208 50th St Ct NW, Suite C104 Gig Harbor, WA 98335 Susie K Nelson	253-851-9600 253-851-9601	CONTACT NAME: PHONE (A/C, No, Ext): E-MAIL: ADDRESS: INSURER(S) AFFORDING COVERAGE INSURER A: Scottsdale Insurance Company INSURER B: INSURER C: INSURER D: INSURER E: INSURER F:	FAX (A/C, No): NAIC #
INSURED Abate of Washington Mick Gillispie P.O. Box 8369 Tacoma, WA 98418			

COVERAGES**CERTIFICATE NUMBER:****REVISION NUMBER:**

THIS IS TO CERTIFY THAT THE POLICIES OF INSURANCE LISTED BELOW HAVE BEEN ISSUED TO THE INSURED NAMED ABOVE FOR THE POLICY PERIOD INDICATED. NOTWITHSTANDING ANY REQUIREMENT, TERM OR CONDITION OF ANY CONTRACT OR OTHER DOCUMENT WITH RESPECT TO WHICH THIS CERTIFICATE MAY BE ISSUED OR MAY PERTAIN, THE INSURANCE AFFORDED BY THE POLICIES DESCRIBED HEREIN IS SUBJECT TO ALL THE TERMS, EXCLUSIONS AND CONDITIONS OF SUCH POLICIES. LIMITS SHOWN MAY HAVE BEEN REDUCED BY PAID CLAIMS.

INSR LTR	TYPE OF INSURANCE	ADDL SUBR INSR WVD	POLICY NUMBER	POLICY EFF (MM/DD/YYYY)	POLICY EXP (MM/DD/YYYY)	LIMITS	
A	GENERAL LIABILITY <input checked="" type="checkbox"/> COMMERCIAL GENERAL LIABILITY <input type="checkbox"/> CLAIMS-MADE <input checked="" type="checkbox"/> OCCUR GEN'L AGGREGATE LIMIT APPLIES PER: <input type="checkbox"/> POLICY <input type="checkbox"/> PRO-JECT <input type="checkbox"/> LOC		CPS1233350	09/30/11	09/30/12	EACH OCCURRENCE \$ 1,000,000 DAMAGE TO RENTED PREMISES (Ea occurrence) \$ 100,000 MED EXP (Any one person) \$ 5,000 PERSONAL & ADV INJURY \$ 1,000,000 GENERAL AGGREGATE \$ 2,000,000 PRODUCTS - COMP/OP AGG \$ 2,000,000	
	AUTOMOBILE LIABILITY <input type="checkbox"/> ANY AUTO <input type="checkbox"/> ALL OWNED AUTOS <input type="checkbox"/> HIRED AUTOS <input type="checkbox"/> SCHEDULED AUTOS <input type="checkbox"/> NON-OWNED AUTOS						COMBINED SINGLE LIMIT (Ea accident) \$ BODILY INJURY (Per person) \$ BODILY INJURY (Per accident) \$ PROPERTY DAMAGE (Per accident) \$
	UMBRELLA LIAB <input type="checkbox"/> EXCESS LIAB <input type="checkbox"/> OCCUR <input type="checkbox"/> CLAIMS-MADE <input type="checkbox"/> DED <input type="checkbox"/> RETENTION \$						EACH OCCURRENCE \$ AGGREGATE \$
	WORKERS COMPENSATION AND EMPLOYERS' LIABILITY ANY PROPRIETOR/PARTNER/EXECUTIVE OFFICER/MEMBER EXCLUDED? (Mandatory in NH) If yes, describe under DESCRIPTION OF OPERATIONS below Y/N <input type="checkbox"/> N/A						WC STATU-TORY LIMITS <input type="checkbox"/> OTH-ER <input type="checkbox"/> E.L. EACH ACCIDENT \$ E.L. DISEASE - EA EMPLOYEE \$ E.L. DISEASE - POLICY LIMIT \$
A	Commercial Applica		CPS1233350	09/30/11	09/30/12		

DESCRIPTION OF OPERATIONS / LOCATIONS / VEHICLES (Attach ACORD 101, Additional Remarks Schedule, if more space is required)
Certificate holder is included as additional insured per CG2026 07/04 as respects Spring opener

CERTIFICATE HOLDER**CANCELLATION**

KITTITA Kittitas County 205 W 5th Ave Ellensburg, WA 98926-2887	SHOULD ANY OF THE ABOVE DESCRIBED POLICIES BE CANCELLED BEFORE THE EXPIRATION DATE THEREOF, NOTICE WILL BE DELIVERED IN ACCORDANCE WITH THE POLICY PROVISIONS. AUTHORIZED REPRESENTATIVE
---	---

© 1988-2010 ACORD CORPORATION. All rights reserved.

THIS ENDORSEMENT CHANGES THE POLICY. PLEASE READ IT CAREFULLY.

**ADDITIONAL INSURED - DESIGNATED
PERSON OR ORGANIZATION**

This endorsement modifies insurance provided under the following:

COMMERCIAL GENERAL LIABILITY COVERAGE PART

SCHEDULE

Name Of Additional Insured Person(s) Or Organization(s)
KITTITAS COUNTY 205 W 5TH AVE ELLENSBURG, WA 98926-2887
Information required to complete this Schedule, if not shown above, will be shown in the Declarations.

Section II - Who Is An Insured is amended to include as an additional insured the person(s) or organization(s) shown in the Schedule, but only with respect to liability for "bodily injury", "property damage" or "personal and advertising injury" caused, in whole or in part, by your acts or omissions or the acts or omissions of those acting on your behalf:

- A. In the performance of your ongoing operations; or
- B. In connection with your premises owned by or rented to you.

[Contact Us](#) | [Connect:](#)[Search OSOS Web Sites](#)

Corporations Division

[Corporations Home](#) [Charities Home](#) [Awards](#) [Public Notices](#)

Search Results

Viewing 1 - 1 of 1 results

A B A T E OF WASHINGTON

A B A T E OF WASHINGTON

UBI Number	600629990
Category	REG
Profit/Nonprofit	Nonprofit
Active/Inactive	Active
State of Incorporation	WA
WA Filing Date	03/21/1979
Expiration Date	03/31/2012
Inactive Date	
Duration	Perpetual

Registered Agent Information

Agent Name	MICK GILLISPIE
Address	11701 94th Ave E
City	PUYALLUP
State	WA
ZIP	98373

Special Address Information

Address
City
State
Zip

[View Additional Information »](#)[Purchase Documents for this Corporation »](#)[« Search Again](#)[» Close «](#)

NEW! - SEARCH APPS ON MOBILE DEVICES



ALL CORPORATIONS DATA DOWNLOAD

[Download the whole Corporations search database](#) in XML format. Average file size is 70 Mb compressed, 750 Mb uncompressed.

Neither the State of Washington nor any agency, officer, or employee of the State of Washington warrants the accuracy, reliability, or timeliness of any information in the Public Access System and shall not be liable for any losses caused by such reliance on the accuracy, reliability, or timeliness of such information. While every effort is made to ensure the accuracy of this information, portions may be incorrect or not current. Any person or entity who relies on information obtained from the System does so at his or her own risk.

Phone Numbers | [Privacy Policy](#) | [Accessibility](#) | [Mobile](#)
Washington Secretary of State - Corporations Division
801 Capitol Way South
PO Box 40234, Olympia WA 98504-0234
(360) 725-0377

Translate our site into:
[Select Language](#)
Powered by Google Translate



ABATE OF WASHINGTON

Itinerary for ABATE of Washington Spring Opener 2012

Thursday June 14, 2012 – general setup, vendors allowed to enter property, inspections for compliance (vendors, security, portable toilets, garbage, ect ;), and general admission.

Friday June 15, 2012 – general admission, no daytime activities planned, evening live music.

Saturday June 16, 2012 – general admission, bike show, bike games, evening live music.

Sunday June 17, 2012 – cleanup, pack up, inspect, and leave

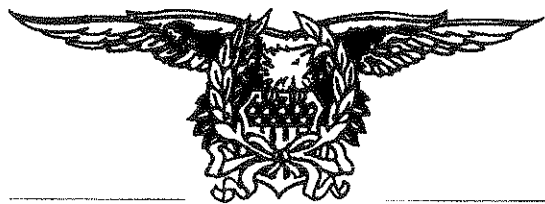

ABATE OF WASHINGTON

Security

Security will be handled by Phoenix Protection Corp., ABATE of Washington Security personnel, and Christian Crusaders. All entrants will go thru the gate I.D. checked if any doubt on age and arm banned to insure that all entrants at least 21 years of age.

Sanitation

Along with the fixed toilets and sanicans already on the property ABATE of Washington will be renting additional sanicans and will be cleaned as often as necessary to make sure they clean and sanitary. For garbage there will be garbage cans placed around the property along with containers for recyclables, there will be a 50 yd. dumpster or two 25 yd. dumpsters to place garbage.

Vendors

All vendors will have the proper permits, fire and safety equipment, and any other requirements made by Kittitas County.

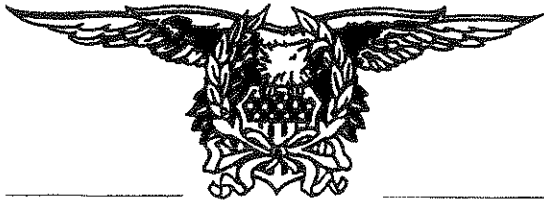

ABATE OF WASHINGTON

ATTEN: Kittitas County Sheriff's Office
Clayton Myers – Undersheriff
205 W. 5th Ave. – Ste 1/Sheriff
Ellensburg, Wa. 98926

To Whom It May Concern:

This is an outline of our Security Plan for Spring Opener 2012

1. A.B.A.T.E. of Washington will provide a mobile command center for housing of gear, radio's and area for processing any issues.

2. Security Manpower:

A. Phoenix Security 160 hours.

B. Christian Crusaders: at Gate.

C. ABATE Security, work with Phoenix and manage ABATE Volunteers' 10-40 working with ABATE security and "roving" with min of 4 at any time
ABATE security personnel to wear orange vests while on duty volunteering as security.
Arm bands will be given to identify that patrons are over 21 and belong in event.

3. Coordinate Sheriffs Department Coordination of Kit-Com and Phoenix Security.
(Tie-in of Radio communications)

4. Will work with Sheriffs Department, Phoenix and ABATE to put together a **crisis plan..**

5. **Roster** of key contacts for event: Security (ABATE), Phoenix Security, Sheriff, emergency personnel, ABATE staff and etc. (Phone Directory of Personal)

6. **Map**-Will provide map prior to event to Fire Marshal and Sheriffs Dept..

Mick Gillispie
State Coordinator
A.B.A.T.E. of Washington

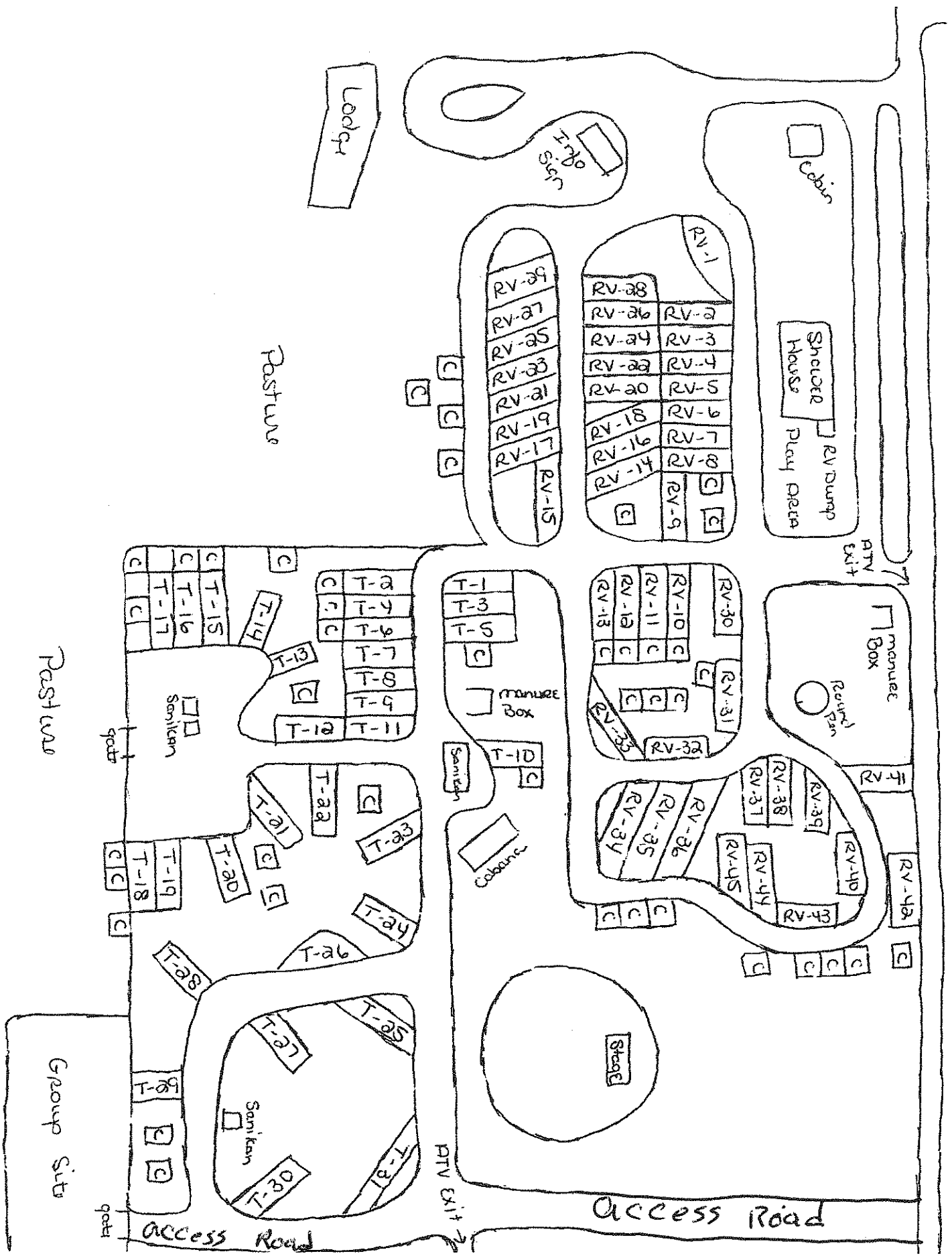

Lodge

Cabin

Shelter

House

RV Dump

Play Area

ATV Exit

Manure Box

Round Pan

RV-41

RV-42

RV-43

RV-44

RV-45

RV-46

RV-47

RV-48

Storage

Sanitation

Manure Box

T-1

T-2

T-3

T-4

T-5

T-6

T-7

T-8

T-9

T-10

T-11

T-12

T-13

T-14

T-15

T-16

T-17

T-18

T-19

T-20

T-21

T-22

T-23

T-24

T-25

T-26

T-27

T-28

T-29

T-30

T-31

T-32

T-33

T-34

T-35

T-36

T-37

T-38

T-39

T-40

T-41

T-42

T-43

T-44

T-45

T-46

T-47

T-48

T-49

T-50

T-51

T-52

T-53

T-54

T-55

T-56

T-57

T-58

T-59

T-60

T-61

T-62

T-63

T-64

T-65

T-66

T-67

T-68

T-69

T-70

T-71

T-72

T-73

T-74

T-75

T-76

T-77

T-78

T-79

T-80

T-81

T-82

T-83

T-84

T-85

T-86

T-87

T-88

T-89

T-90

T-91

T-92

T-93

T-94

T-95

T-96

T-97

T-98

T-99

T-100

T-101

T-102

T-103

T-104

T-105

T-106

T-107

T-108

T-109

T-110

T-111

T-112

T-113

T-114

T-115

T-116

T-117

T-118

T-119

T-120

T-121

T-122

T-123

T-124

T-125

T-126

T-127

T-128

T-129

T-130

T-131

T-132

T-133

T-134

T-135

T-136

T-137

T-138

T-139

T-140

T-141

T-142

T-143

T-144

T-145

T-146

T-147

T-148

T-149

T-150

T-151

T-152

T-153

T-154

T-155

T-156

T-157

T-158

T-159

T-160

T-161

T-162

T-163

T-164

T-165

T-166

T-167

T-168

T-169

T-170

T-171

T-172

T-173

T-174

T-175

T-176

T-177

T-178

T-179

T-180

T-181

T-182

T-183

T-184

T-185

T-186

T-187

T-188

T-189

T-190

T-191

T-192

T-193

T-194

T-195

T-196

T-197

T-198

T-199

T-200

T-201

T-202

T-203

T-204

T-205

T-206

T-207

T-208

T-209

T-210

T-211

T-212

T-213

T-214

T-215

T-216

T-217

T-218

T-219

T-220

T-221

T-222

T-223

T-224

T-225

T-226

T-227

T-228

T-229

T-230

T-231

T-232

T-233

T-234

T-235

T-236

T-237

T-238

T-239

T-240

T-241

T-242

T-243

T-244

T-245

T-246

T-247

T-248

T-249

T-250

T-251

T-252

T-253

T-254

T-255

T-256

T-257

T-258

T-259

T-260

T-261

T-262

T-263

T-264

T-265

T-266

T-267

T-268

T-269

T-270

T-271

T-272

T-273

T-274

T-275

T-276

T-277

T-278

T-279

T-280

T-281

T-282

T-283

T-284

T-285

T-286

T-287

T-288

T-289

T-290

T-291

T-292

T-293

Tents & Motorhomes

Access Road

Tents only

Access Road

Tents & Motor home

Access Road

Group Site

Access Road

Tents & Motorhomes



ABATE

OF WASHINGTON

We ABATE of Washington are applying for a Penal Bond waiver as we do not have any activities on any public property.

We ABATE of Washington are applying for a waiver to the noise ordinance to the time of 1:00 AM for live music.

LYLE A. AND DEBORAH L. COYLE
COYLEDL44709
360-897-8963
13410 CEDAR CTE
BONNEY LAKE, WA 98391

2188
82283251
789291650370

11-14-11

Date

Pay to the Order of Kittitas Board of Co. Commissioners \$ 200.⁰⁰

Two Hundred and 00/100

Dollars

Security Features



1ST Security Bank of Washington
Lynnwood Branch
P.O. 97000
Lynnwood, Wa 98046-9700

For *Event Permit*

For *Event Permit*

1:3251822891:7892916503701* 2188

MP



Kittitas County Office Of The Treasurer
Deanna Jo Panattoni, Treasurer
205 W 5th Avenue, Suite 102
Ellensburg, Wa 98926
Phone (509) 962-7535 Fax (509) 933-8212

Cash Receipts

Receipt Number: 2011-8772 Date: 11/18/2011

Received From: MANDY ROBINSON-DEPUTY CLERK OF THE BOARD-KRI

Check Amount: \$200.00

Cash Amount: \$0.00

Eft Amount: \$0.00

Total Amount: \$200.00

Deputy: JULIEC Receipt Type: CHK

Template:

Comments:

SPECIAL EVENT PERMIT FEE FROM ABATE (LYLE AND DEBORAH COYLE) - CSR - 2011-5566

<u>FundCode</u>	<u>GlCode</u>	<u>Description</u>	<u>Amount</u>
001	1632171	SPECIAL EVENTS FEE	\$200.00
Total Amount:			\$200.00

Kittitas County Treasurer's Office

Submitted By: JULIE COPPOCK