

KITTITAS COUNTY  
DEPARTMENT OF PUBLIC WORKS

**AGENDA STAFF REPORT**

**AGENDA DATE:** April 5, 2016

**ACTION REQUESTED:** Request to set a Public Hearing for May 3, 2016 to consider an irrigation franchise with Washington Fruit, a/k/a Selah Ranch LLC, along Lawrence Road.

---

**BACKGROUND:** Washington Fruit, a/k/a Selah Ranch LLC has applied for a Commercial Irrigation Franchise within the Lawrence Road Right of Way. The proposed project of planting an apple orchard requires irrigation pipe to be installed within the Lawrence Road Right of Way to reach the northwest corner of the Applicant's property to irrigate said apple orchard.

The Franchise Application is complete and the appropriate Application Fee has been collected.

**INTERACTION:** Public Works

**RECOMMENDATION:** Set a public hearing on May 3, 2016 at 2pm and advertise accordingly, to consider an Irrigation Franchise Application from Washington Fruit, a/k/a Selah Ranch LLC across Lawrence Road.

**ATTACHMENTS:** Vicinity Map  
Franchise Application

**LEAD STAFF:** Mark Cook  
Director of Public Works

**Public Notice**  
**Kittitas County, Ellensburg WA**

The Board of Kittitas County Commissioners will meet at 2:00 pm on May 3, 2016 at the Commissioners' Auditorium, 205 W. 5th, Room 109, Kittitas County Courthouse, Ellensburg, WA to consider a franchise application by Washington Fruit, a/k/a Selah Ranch LLC for an irrigation franchise along Lawrence Road.

More information is online at <http://www.co.kittitas.wa.us/notices/>.

---

Clerk of the Board

Publish:

Daily Record: 04/07/16; 04/14/16; 04/28/16

For more information, contact Public Works

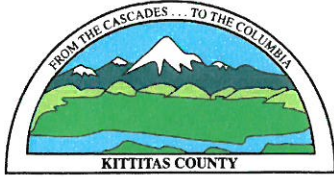

## KITTITAS COUNTY DEPARTMENT OF PUBLIC WORKS

411 North Ruby Street, Suite 1, Ellensburg, WA 98926  
TEL (509) 962-7523 FAX (509) 962-7663

### FRANCHISE APPLICATION

#### FOR FACILITY IN COUNTY ROAD RIGHT-OF-WAY

Rec # 9495

#### Fee Schedule

**Commercial and Residential Application - Kittitas County Department of Public Works (Non-Refundable): \$750.00**

This form precedes the legal agreement set forth by the county when applying for use of road right of way for a franchise facility installation. The legal document is required by Kittitas County Code 12.56 specific to Electrical, Telephone, Natural Gas, Cable TV, Sanitary Sewer, Domestic Water, or Irrigation Water which is designated for commercial use and distribution.

Please type or print clearly in ink. Attach additional sheets as necessary. Pursuant to KCC 15A.03.040, a complete application is determined within 28 days of receipt of the application submittal packet and fee.

Owner/Applicant WASHINGTON FRUIT / SELAH RANCH LLC / NICK PUTH Date 2/10/16  
Address 1111 RIVER RD City YAKIMA State WA Zip 98902  
Phone 509-654-6758 E-mail nick@washfruit.com

Type of Franchise IRRIGATION  
Affected County Road LAWRENCE RD.  
Assessor's Parcel No. 16494, 21037

Please provide a brief description below of the proposed franchise:

WE ARE PLANTING AN APPLE ORCHARD IN BADGER POCKET. IN ORDER  
TO IRRIGATE 10 ACRES IN THE NW CORNER WE NEED TO CROSS  
LAWRENCE ROAD WITH PVC PIPE.

Kittitas County expects entities applying for use of county maintained right of way specifically address public benefit when applying for franchise and associated right of way use. Please provide a brief description of the public benefit supported by this application (please attach supplement sheet as necessary):

PROVIDING SPRINKLER IRRIGATION TO PARCEL 21037 WILL ALLOW US TO  
SUCCESSFULLY FARM APPLES AND BRING MORE HONEYCISP TO THE MARKETPLACE.

|   |                          |                          |
|---|--------------------------|--------------------------|
| Application Received by (PW Staff Signature)<br><u>Chader</u> | Date:<br><u>02.10.16</u> | Receipt #<br><u>9495</u> |
|---|--------------------------|--------------------------|

Revised on 09/09/2016

✓ #84170



Contour Interval: 10FT

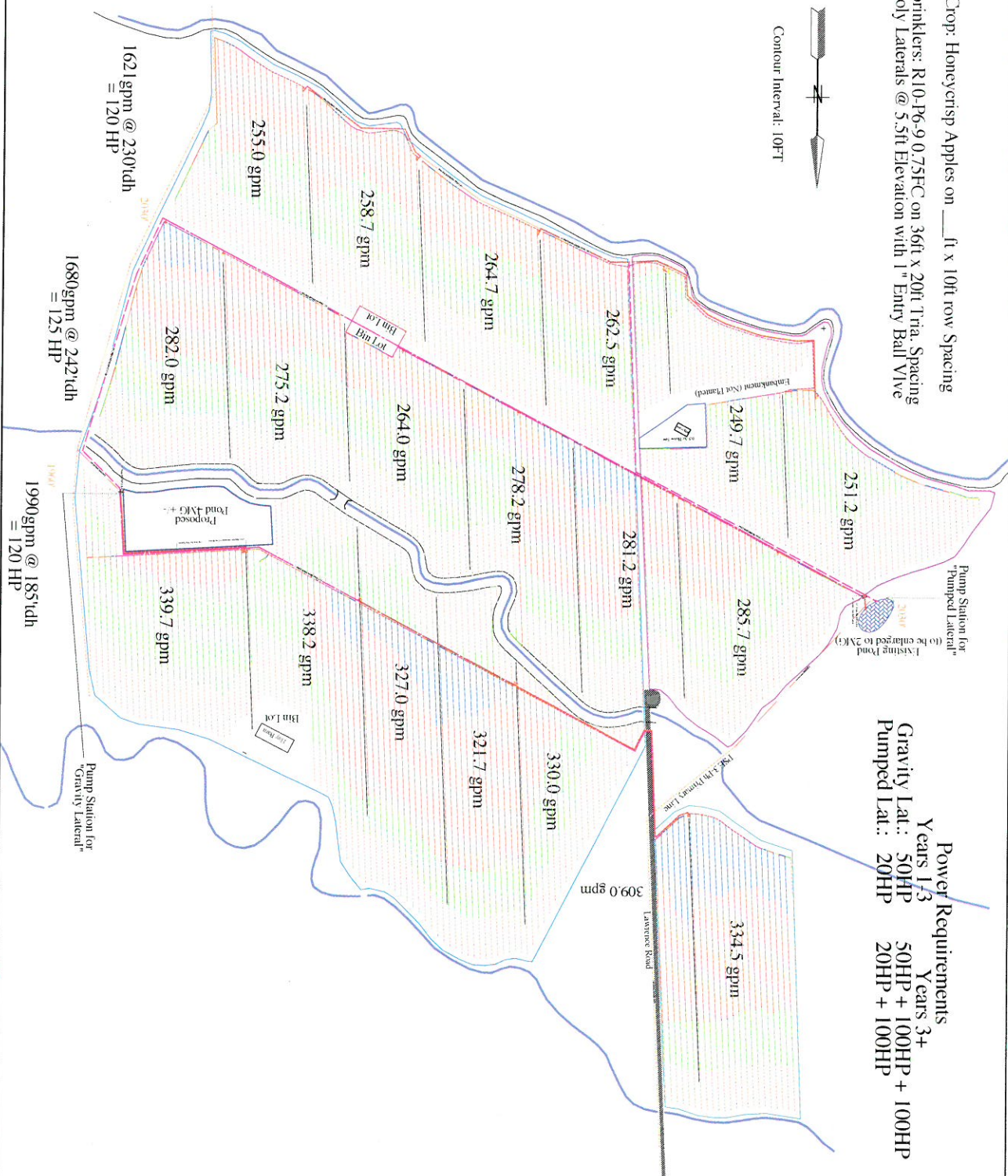

|                    | Years 1-3 | Years 3+             |
|--------------------|-----------|----------------------|
| Power Requirements |           |                      |
| Gravity Lat.: 50HP |           | 50HP + 100HP + 100HP |
| Pumped Lat.: 20HP  |           | 20HP + 100HP         |

 **ASSOCIATION  
SPECIALISTS**  
815 Wilshire Way, Cambridge, MA 02140 T 508-662-5060

**WFP RODEO Ranch**  
**Blocks & UT-OT System**  
Designed by: Jon Hayler, CID  
Date: Revised 1/12/2016

Designed by: Jon Hayler, CID  
Date: Revised 1/12/2016

Jon Hayler, CID  
Revised 1/12/2016

Pipe key

- |                 |                        |
|-----------------|------------------------|
| 12 <sup>a</sup> | Class 125 PS-SW/PC-Rhe |
| 12 <sup>b</sup> | Class 125 PS-SW/PC-Rhe |
| 58 <sup>a</sup> | Polyurethane Tung 2ir  |
| 34 <sup>a</sup> | Polyurethane Tung 2ir  |
| 34 <sup>b</sup> | Class 20 PS-SW/PC-Rhe  |
| 1 <sup>a</sup>  | Polyurethane Tung 2ir  |
| 1 <sup>b</sup>  | Class 20 PS-SW/PC-Rhe  |
| 1 <sup>c</sup>  | Class 125 PS-SW/PC-Rhe |
| 1 <sup>d</sup>  | Polyurethane Tung 2ir  |
| 11 <sup>a</sup> | Class 125 PS-SW/PC-Rhe |
| 11 <sup>b</sup> | Class 125 PS-SW/PC-Rhe |
| 2 <sup>a</sup>  | Class 125 PS-SW/PC-Rhe |
| 2 <sup>b</sup>  | Class 125 PS-SW/PC-Rhe |
| 4 <sup>a</sup>  | Shuttle 40-SW/PC-Rhe   |
| 4 <sup>b</sup>  | Class 125 PS-SW/PC-Rhe |
| 5 <sup>a</sup>  | Class 125 PS-SW/PC-Rhe |
| 6 <sup>a</sup>  | Class 10 PS-SW/PC-Rhe  |
| 8 <sup>a</sup>  | Class 10 PS-SW/PC-Rhe  |
| 10 <sup>a</sup> | Class 10 PS-SW/PC-Rhe  |

Sprinkler / Valve key

#TEXT#

Scale: 1" = 160' File: WFP Prodeo Ranch US



IRRIGATION FRANCHISE FOR WASHINGTON FRUIT, SELAH RANCH LLC, ETC

